

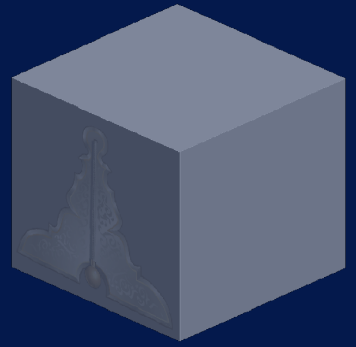

FREEMASONS
New Zealand

CENTRAL DIVISION

'Central Today'



The Central Division Newsletter.

4 April 2020

Issue 1

In this Issue of Central Today

- Editor's Desk
- Links
- DivGM Notes
- Helping the homeless
- Zooming Mad
- L'Arche Charity
- Girl Power
- Taranaki Musings
- Eastland Ruahine Dispatch
- Ruapehu Mummerings
- 102 Years ago
- One Charge Challenge

Just for Fun

- Film Quiz
- Masonic Word Search
- Figure of Speech

The Freemasons
Charity

Editorial

Welcome to the first issue of 'Central Today' the newsletter for the Central Division. It is not a replacement for any of our current websites, social media and individual district and lodge newsletters.

It is my great pleasure and honour to be asked to be Editor, and I would like to extend my

Sincere thanks to Jo my wife for allowing me to take time out to do this, the Divisional Grand Master for his vision for a wider communication tool, and the District Grand Masters that have contributed articles with no arm twisting. I just hope I do it justice!

It is our hope that you find these few pages entertaining, educational and informative,

Please share our ramblings with your spouses, partners, family and friends as we wind through autumn's path.

Be safe in your respective bubbles!

Ash



Grand Master
Watch Video # 1

Grand Master
Watch Video # 2

Grand Master
Watch Video # 3

Freemasons NZ
Website

Central Division
Website



Email the
Editor

What is Zoom?

Zoom is a cloud-based video conferencing service you can use to virtually meet with others, either by video or audio-only or both, all while conducting live chats, and it lets you record those sessions to view at a later date.

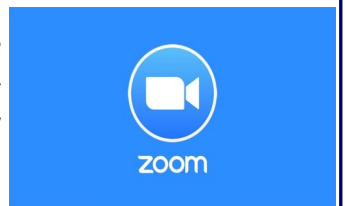

When people are talking about Zoom, you'll usually hear the following phrases: Zoom Meeting and Zoom Room. A Zoom Meeting refers to a video conferencing meeting that's hosted using Zoom. You can join these meetings via a webcam or phone. Meanwhile, a Zoom Room is the physical hardware setup that lets companies schedule and launch Zoom Meetings from their conference rooms.

We Freemasons prefer to call them 'Social Gatherings' rather than meetings. [Zoom Video Tutorials](#)

From The Divisional Grand Master's Desk

Brethren

We live in interesting times. My parents spoke of the great depression; and while they were both just children at the time for many years their parents (my grandparents) spoke of the personal sacrifices all families had to make during this time. The great depression was largely triggered by the 1929 share market crash - but its 'tentacles' eventually reached every corner of the globe.

The Corona Virus is unlikely to have the same generational impact on New Zealand as the great depression did - however I am certain it will take some years for things to truly return to normal.

I am confident that history will remember the quick decisive action of our government kindly. Moving to Level 4 would have come as a shock to many citizens with some seeing it as an over reaction at the time. We don't have to look too far abroad to already see the more dire impact occurring in countries that have chosen trade and commerce above isolation and eradication. I have looked at the covid regimes of a number of jurisdictions around the world and I can truly say there is nowhere I'd rather be right now than in New Zealand.

Freemasonry has a 'survival gene' that has held it in good stead over the past 500 years - even before the formation of the Grand Lodge of England. Our organisation has survived civil and world wars; plagues and pandemics; pestilence and persecution. Part of our strength is that we are non-partisan; religiously neutral; and we don't concern ourselves with plots and conspiracies.

Very few people alive today will have ever experienced anything like what we are witnessing today. Social distancing has temporarily robbed us of face to face contact. It is that contact that underpins the very essence of fellowship within our order. At first glance it is a tragedy - but on deeper examination it truly is an opportunity. Freemasonry will survive Covid 19 like it has survived so many other challenges over the centuries - but don't be surprised if the Freemasonry you witness in the future is a little different to what you have experienced in the past.

For more than a month now the 5 District Grand Master's across the Division have been engaging at increasing frequency to ensure that our Lodges and our brethren are safe - that clear guidance is given in areas of doubt - and that information and resources are readily available to Lodges when they need it. For the past two weeks I have been providing written daily updates to District Grand Masters; and we meet via Zoom for 40 minutes each Saturday afternoon to keep each other appraised of challenges and opportunities.

Likewise - I am in daily contact with the other Divisional Grand Masters; we meet formally once a week via Zoom; and talk on the phone often. I know our Grand Master, Deputy Grand Master, President of the Board of General Purposes and Grand Almoner are doing the same thing. Our Board of General Purposes, which normally meets quarterly, is presently meeting fortnightly.

This "call to arms" across the depth and breadth of our organisation is driven by a determination to maintain close contact with Lodges and brethren. I am aware that District Grand Masters are holding zoom meetings with Masters and Secretaries; and that many lodges are also meeting 'virtually' both to conduct non-ceremonial business; and to maintain social interaction with brethren. In the last week - 43 such meetings have occurred across the Division - a great achievement.

This is also an important time to keep in touch with our elderly brethren and widows. Many of them are genuinely frightened - and so a reassuring phone call is often all they need to put their mind at rest. District Grand Masters are working hard to ensure Lodges keep these important lifelines open. This should, however, become the new normal. I know that for many Lodges and many almoners what they are doing now is what they've always done. I find this very reassuring.

Be sure to check out both the National Website and the Divisional Website frequently. Our Grand Master publishes a video every Friday giving everyone an update on topical issues. In the interests of stemming the flow of mail into your inbox - reminders won't be sent to brethren when new content is posted. I encourage brethren to treat the national and divisional website the same way you do your favourite news site. Check it out often.

Continued next page

Congratulations to Ash Williamson for volunteering to compile this periodic Divisional newsletter. It is crammed full of interesting stuff from across the Division (and further afield). The objective is to provide opportunities for all brethren to immerse themselves in masonic activity albeit at an appropriate social distance.

Your Divisional and District Leaders are still relatively new in their roles; it's been less than 6 months since our Grand Installation. I have received a few emails over the past few weeks from brethren across the Division curious about what my vision is for the Division; and asking what skills I bring to the table that entitle me to shape the next three years for this fine Division. I also often get asked about my personal credentials; what I do for a job; whether I am married and have children - and some also ask about my masonic credentials.

In the next edition of this newsletter I plan to share with you my vision for the rest of my term. I will invite you to share your vision too - because regardless of how freemasonry lands from the current crisis - its members will continue to stand shoulder to shoulder - as we have always done. As for my personal and Masonic credentials to get us where we need to be - let's talk about those too - and you be the judge.

In the meantime - stay home; stay safe; and be kind to one another.

Russ

Refectory Savings go to help DCM Wellington.

Since the lockdown many Lodges have been keeping in touch by Zoom, Hangouts or other similar video conferencing apps. In this way VW Bro Mick Turner Dist GM Kapiti Wellington arranged for the Masters and Secretaries to join him in a Friday Night Drinks Zoom session. As part of this, he offered a competition between the Lodges for a \$500 donation towards a charity project that could be run during lockdown and would fit with the current climate.

A suggestion was made from W Bro Terry Wellington of Westminster Lodge to work with DCM and ascertain what we can do to help them. DCM provide a service primarily for those they are helping in accommodation whose resources don't stretch to having sufficient to buy food. (Note DCM do not encourage those on the street with food parcels as it does not encourage rough sleepers to move into accommodation). With the increase in those DCM have accommodated they have an urgent need for grocery and other items to ensure the well-being of their clients. All the Masters and Secretaries in the meeting embraced this as the option that they wanted to pursue. The idea is that each Lodge contributes what it would have spent on Refectory expenses (hopefully around \$500 or more!) and we can turn this around quickly and help DCM in a meaningful way during the current crisis. At least half of the Kapiti Wellington Lodges have already contributed to this project in one week. How good is that? It is fantastic that Lodges can see the opportunity to do good things for people that reside outside their immediate area and this project will be followed up with another joint project further up the coast. Further information will be forthcoming as we progress.



DCM is continuing to support the most marginalised people in our city through the COVID-19 crisis period. Thank you to all those who have got in touch to ask how you can help – [here are some ideas.](#)



WHO FORGOT THE CLOCKS WHEN BACK AN HOUR AT THE WEEKEND?

**A FREEMASON SHOULD BE LIKE A GOOD WATCH – AN OPEN FACE,
BUSY HANDS, PURE GOLD, WELL REGULATED & FILLED WITH GOOD**

We've Gone Zooming Crazy, and we are Loving it!!

Freemasons from around the division have gone zooming mad whilst in lockdown, and we think it's great news.

Being able to stay connected at this time is so important, even if it just for a couple of minutes. Well done you guys, awesome effort.



If your Lodge hasn't Zoomed yet, give it a go, you might be pleasantly surprised how many of you Brethren will join in.

L'Arche—District Project Reaches it's Target, by Kapiti Capital Capers



Over the last couple of years the Freemasons of Kapiti Wellington have been fundraising for a charity called L'Arche in order to purchase them a new disabled vehicle for their use at their houses in Paraparaumu.

L'Arche was founded in 1964 and driven by the institutionalisation, isolation and loneliness of people with intellectual disabilities. It was started in Trosly-Breuil, a village in France in house named "L'Arche", a French word for "the ark" in the biblical story of Noah and the flood. Word spread and young people from various parts of the world came to the community in Trosly to share their life with people with

an intellectual disability. Some of these young people were so inspired by the vision of L'Arche that they founded a L'Arche community in other countries. In 1998 the L'Arche Kapiti community was established in Paraparaumu, New Zealand. Today, the International Federation of L'Arche consists of over 130 communities in more than 30 countries around the world. Each L'Arche community operates independently, but all are united in their commitment to the L'Arche Statement of Identity and Mission.

In New Zealand the L'Arche community is made up of about 60 people with and without learning disabilities sharing their lives together and are the only L'Arche community in New Zealand.

They work to celebrate the gifts of each person, whatever their abilities and disabilities. They like to be creative and responsive, finding new ways to appreciate the gifts of each person. This can be through parties, services and just day to day life. They provide a strong sense of belonging. They like to be rich in fellowship and companionship (sentiments that should strike a chord with Freemasons), and able to organise events together and in small groups.

Inspired by the work that they do, VW Bro Graeme Webb Grand Chaplain approached VW Bro Russell Pratt the then District 19 Dist GM about the L'Arche community and the charity with a view to purchasing a used disabled vehicle so that they can get their core members out and about (under normal circumstances). Help was then enlisted and several events were run including a "Wine Options" night in the empty shell of our new masonic building in Hutt Road and a number of the brethren completing the Rimutaka Incline Run/Walk together with some very generous financial donations from the Masonic Club, the Order of St Lazerus, St Andrews Lodge and Hinemoa-Kairangi to mention a few. Gazley Motors were contacted and agreed to support the project in conjunction with VW New Zealand and offered a highly discounted specially adapted VW Caddy.

At the end of February, this vehicle was presented to L'Arche at a morning tea at their house. A number of Masons were present including VW Bro Mick Turner Dist GM for Kapiti Wellington who presented the vehicle. He said "I was overwhelmed by the work that L'Arche do in enriching the lives of those less able people in our community and the commitment that they show to their core members. It validates all the hard work that we had done across the District to get this project over the line and was indeed hugely satisfying that the Masons of Kapiti Wellington have stepped up in this way." Mick added "A big thank you to everyone who played a part in delivering this project. Make no mistake, this has changed the lives of those L'Arche core members and helpers for the better, thank you all"

The vehicle is branded with the Freemasons Logo and will remain as an advert for our benevolence across the District for many years to come. *Mick*



Girl Power

This space is reserved for stories and news items from our wonderful wives and partners that support us

The Speculative Guild of Ladies

A Social Group for Ladies Associated with
New Zealand Freemasons.



The social group 'The Speculative Guild of Ladies' held their inaugural coffee meeting at Viv's Kitchen, Sanson (famous for the cream horns and fifties American decor). The 'SGL' is the brainchild of Jo Williamson and has been formed to bring ladies who are connected to a Mason, together outside of Freemasonry for general fun and interest. A small group of the members attended this first outing and from all accounts they had a great time and maybe a few cakes!. Jo informs me that they have already planned another event, this time at the weekend so more of our lovely ladies can attend. There are 15 ladies currently following the SGL on social media, and they are currently working on an online website. So lads they have laid the gauntlet down, about time the 'Speculative Guild of Gentlemen' had their first event.



Taranaki Musings

When thinking of something to contribute to this publication, I was reminded of a couple of the “lighter things” that have occurred over the years causing much merriment to all.

I think we’ve all heard several new parts of the ritual from time to time, “Worshipful Mistress,” “Attacks of the Invidious’ and so on but there are a couple that have stood out which I thought worthy of further mention.

The first occurred at a degree opening at a Lodge in Whakatane many years ago where the Junior Warden at the opening stated, “an instrument containing an angle of 45 degrees or the fourth part of a circle,” which as you may imagine caused some strange looks and some stifled laughter, not that funny in itself until the closing, when prior to sounding the gavel he said, “and while I’m on my feet, I should like to give back to the Lodge the 45 degrees I purloined at the start,” For a new Junior Warden, it went down very well, his quick wittedness serving him well to this day.

The other happened at my Lodge in Tauranga. We were conducting a Past Master’s degree ceremony. The Lodge, like many (one of my bete-noirs), adopted the directions in italics as part of their ritual, in this case the directions as to where the candidates feet are placed prior to movement. The Senior Deacon (a ring-in from another Lodge, not using said ‘directions’) addressed the candidate, “standing perfectly erect, one foot pointing North, the other foot pointing South”

I still chuckle when thinking of that poor chap trying to stretch his feet into an impossible position and the look on his face. As may be imagined, with the ceremony observing due decorum, the lodge room collapsed in fits of laughter. Luckily, it being a bone-fide degree working, the solemnity of the occasion was restored quickly without detriment to the working.

Roly Blake



Eastland Ruahine Dispatch

I was extremely impressed with the enthusiasm and commitment of the new District 17 team. Over the summer we rehearsed the installation ceremony five or six times with the valuable assistance of past officers. In February, it was a proud moment for me to install Worshipful Bro Don Casagrande as Master of Lodge Haeata No 272, my Mother Lodge.

Later in the same week I had the pleasure of installing VW Bro Ken Edney into the Chair of Hawke’s Bay Day Time Lodge No 453. Both occasions were well attended by brethren from throughout the District and carefully organised Ladies programmes were well subscribed and enjoyed. It was a great start to our term.



Bill Feetham, Nigel Friggens, Paddy Driver, Graham Bundle

Having “bloodied” the gavel, baton and wands we were geared up for what was to be a very busy month of installations including the Centennial Installation of Lodge Omarunui No 216 with visit by the Most Worshipful GM. It was a particularly courageous and selfless decision for Worshipful Master Bruce Greathead, Master Elect, Brother Ross Braybrook and the management team to pull the plug on these celebrations. This occurred on the day before the Level-2 alert was announced and the pandemic threat was only beginning to be realised. Looking back, it was exactly the right call to make but at the time things were not so clear.



As the level-4 alert and lock down has come into effect lots of stories of disruption and plight have been reported in the media. I learned that WB Richard Mercer, WM of Lodge Waikaremoana and his wife Caryl had a very worrying time getting back from their trip to see relatives in Australia. Speaking to Richard yesterday, he was relieved to be safely in lockdown on his property in Wairoa after a gruelling and uncertain flight

A Grand Job of Social Distancing



Congratulations to WBro. Balt PGIG and his lovely wife Hester, they officially became Kiwi's this week with the receipt of their citizen certificates

VW Bro. Mike Kendrick joined in with our Zoom social gathering this week, and took his social distancing very seriously

Well we think it was Mike, we are still wondering?

1

Level 1 – Newer members

Under the Phone Guidance of your mentor or Lodge Education Officer:

Pick a straightforward charge from the Blue book

Eg: Charge after investiture

2

Level 2 – New Officers

Practice Openings and closings of all three degrees **for your current and for your next position** on the Ladder. Practice with the brother immediately above you on the ladder.

3

Level 3 – More Experienced Charge Givers

Learn a new Charge: In consultation with you Lodge DOC or Secretary, find out which of the longer charges (any degree or tracing board) could do with having

Submitted by Nigel

Ruapehu Murmuring

I hope you are all coping well in your respective bubbles and those like me who are classed as essential services are taking the appropriate precautions to keep yourselves safe.

As part of our campaign to **“Speak out, Step up and Show Up”** we have decided to be more visible in our district, and are looking at developing a small team that will attend shows and events to promote Freemasonry and raise funds for the district project or Lodge benevolence. To aid this we have purchased a 4 x 4 metre Gazebo, emblazoned with the Freemasons NZ and our District Logos. So far six Lodges have contributed \$600 toward the project with the half of the total being donated by VW.Bro. Laurie Hunt PDistGM. Laurie was a keen supporter of our public shows and could always be relied on for manning a table. Hopefully the other seven Lodges will jump on board with a donation as we still need \$700 to reach half way. The Gazebo is top of the range and comes with a ten year warranty on the frame.

The Gazebo will be delivered when the company in Auckland returns to work.

The Power of Freemasonry

A message plea from Old Monktonian's Lodge Cardiff, South Wales Masonic Province.

A short while ago I received a plea of help from Bro. Alwyn Evans, in Cardiff via our Ruapehu Face book page. Alwyn was concerned about his cousin in Wanganui who had has a stroke and was not fairing well, Ms. Ceinwen Welsh had been a midwife in Wanganui for many years and would have more than likely delivered a fair few Freemasons! Bro. Craig Ancell our District Charity Officer, made contact with Ms Welsh and whilst observing the current restrictions has offered to provide some much needed supplies. When we all get back to normal we will asses the situation further. Well done Craig.

This day, 5 April 1918 World News.

Operation Michael – British forces halted the German advance at Ancre, France, ending the first stage of the Spring Offensive.[44] The offensive had cost the Allies some c. 255,000 men including 177,739 killed, British casualties. As well, the German captured 75,000 prisoners and some 1,300 artillery pieces. German casualties were also massive, with 250,000 casualties.[45] Despite advancing more than 65 km (40 mi) and capturing 3,100 km² (1,200 sq mi) of French territory, the offensive achieved few of the strategic objectives of the operation.

Battle of Rautu – The Red Guards broke through the White Guard line and attempted to escape to Petrograd. However, the column was caught in a machine gun cross-fire in a valley near Kuolemanlaakso, Finland at the Russian-Finish border, where 400 men were slaughtered along with dozens of civilians from the nearby village. Another 800 to 900 Red Guards were taken prisoner. The Whites Guards lost 270 casualties in the final two days of the battle. The Kuolemanlaakso valley was nicknamed the "Valley of Death" following the massacre.

Battle of Tampere – The Red Guards barricaded in the town center of Tampere, Finland surrendered to the White Guards.

Royal Air Force pilot Lieutenant C. H. Noble-Campbell of [No. 38 Squadron](#) was wounded in the head by machine-gun fire while attacking German Zeppelin L 62 but was able to return safely to base. It was the only occasion on which an attacking airman was wounded in combat with an airship.

The Curtiss USAO-1 aircraft was first flown.



The Spanish flu (also known as the 1918 flu pandemic) was an unusually deadly influenza pandemic. Lasting from January 1918 to December 1920, it infected 500 million people – about a quarter of the world's population at the time. The death toll is estimated to have been anywhere from 17 million to 50 million, and possibly as high as 100 million, making it one of the deadliest pandemics in human history.

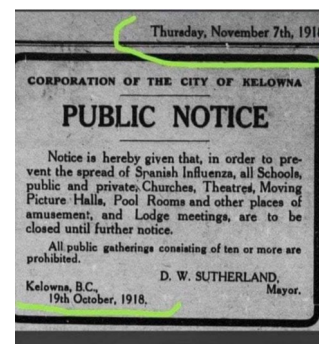

Challenge Yourself



Not every Master Mason feels the urge to stand up in front of his Lodge and deliver a charge. I didn't many years ago and would have died of fright at the very thought. But when you have taken the time to learn a charge, and you do it well for the 1st time, the personal buzz is amazing. If it doesn't go well, you dust yourself off and try it again some other meeting. That's why we are promoting 'The One Charge Challenge'. So turn off the TV and stop doing all those chores and own a charge, any charge from any degree! The challenge is open to all Freemasons.

Test your Knowledge

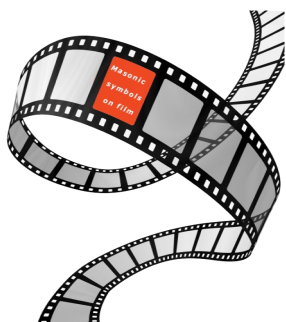

These six films all have references to Masonic symbols Can you place them in the right order ?

- ☐ Magnolia (1999)
- ☐ Prisoners (2013)
- ☐ Aliens (1986)
- ☐ League of Extraordinary Gentlemen (2003)
- ☐ True Grit (2010)
- ☐ Tombstone (1993)

The answers will be in the next issue



Masonic Word Search

F	B	C	H	I	R	A	M	E	E	C	Z	P	I	L	L	A	R	R	S
Q	A	T	I	N	N	E	R	G	U	A	R	D	B	P	D	E	W	X	C
A	T	F	B	N	R	A	I	Y	S	C	A	N	D	I	D	A	T	E	L
J	O	M	O	L	P	N	H	P	J	K	P	I	H	E	S	E	I	H	O
O	K	S	Q	U	O	N	L	T	R	T	R	S	V	Z	R	A	I	S	E
T	E	W	A	T	R	D	E	R	G	R	O	A	T	A	K	R	O	N	C
K	N	Z	K	A	C	P	G	N	M	N	N	S	U	T	W	X	Y	M	O
E	I	Q	E	R	H	F	T	E	M	I	N	Q	G	A	M	E	C	G	P
N	P	F	R	A	F	E	L	L	O	W	C	R	A	F	T	A	O	R	O
S	K	I	I	N	L	L	I	T	G	H	G	A	V	E	L	S	L	U	R
T	G	K	I	N	G	S	O	L	O	M	O	N	M	A	T	R	U	I	C
E	F	U	O	C	O	G	F	D	C	K	D	U	K	K	E	A	M	L	H
W	L	F	Y	R	X	C	O	L	U	M	E	T	Y	L	M	E	N	R	S
A	A	C	H	A	M	B	E	R	H	A	P	N	I	N	P	R	S	H	K
R	R	O	K	F	C	H	I	S	E	C	B	A	S	H	L	A	R	Q	S
D	G	L	M	T	Y	L	E	R	O	B	F	O	G	G	E	M	U	G	Q
X	A	P	A	P	L	E	R	L	M	O	R	A	I	S	E	D	K	E	U
S	V	G	X	T	H	E	L	D	E	G	R	E	E	M	E	N	T	A	A
S	E	S	R	S	G	R	A	N	D	M	A	S	T	E	R	Q	W	A	R
C	L	V	I	D	C	H	I	S	E	L	C	F	R	I	E	N	D	S	E

APRON
 ASHLAR
 CANDIDATE
 CHAMBER
 CHISEL
 COLUMNS,
 CRAFT
 DEGREE
 EGYPT
 FELLOWCRAFT
 GAVEL
 GRANDMASTER
 HIRAM

INNERGUARD
 KINGSOLOMON
 LODGE
 PILLAR
 PORCH
 RAISED
 SQUARE
 STEWARD
 TEMPLE
 TOKEN,
 TYLER
 ZEAL
 FRIEND

Answers in the next issue

A Figure of Speech

Here is a fun challenge for you to test your knowledge of idiomatic and figurative speech.

I stumbled upon this absolutely brilliant cartoon by Ella Baron in the Times Literary Supplement on Twitter.

Ella has illustrated twenty-seven figurative language terms. They are a mixture of metaphors and similes.

I wonder if you can identify all of them. At first glance, it looks like an easy puzzle to solve. But once you get past identifying the first ten to fifteen idioms, it gets a little more difficult. She has been very cunning, indeed.

Perhaps, as cunning as a fox.

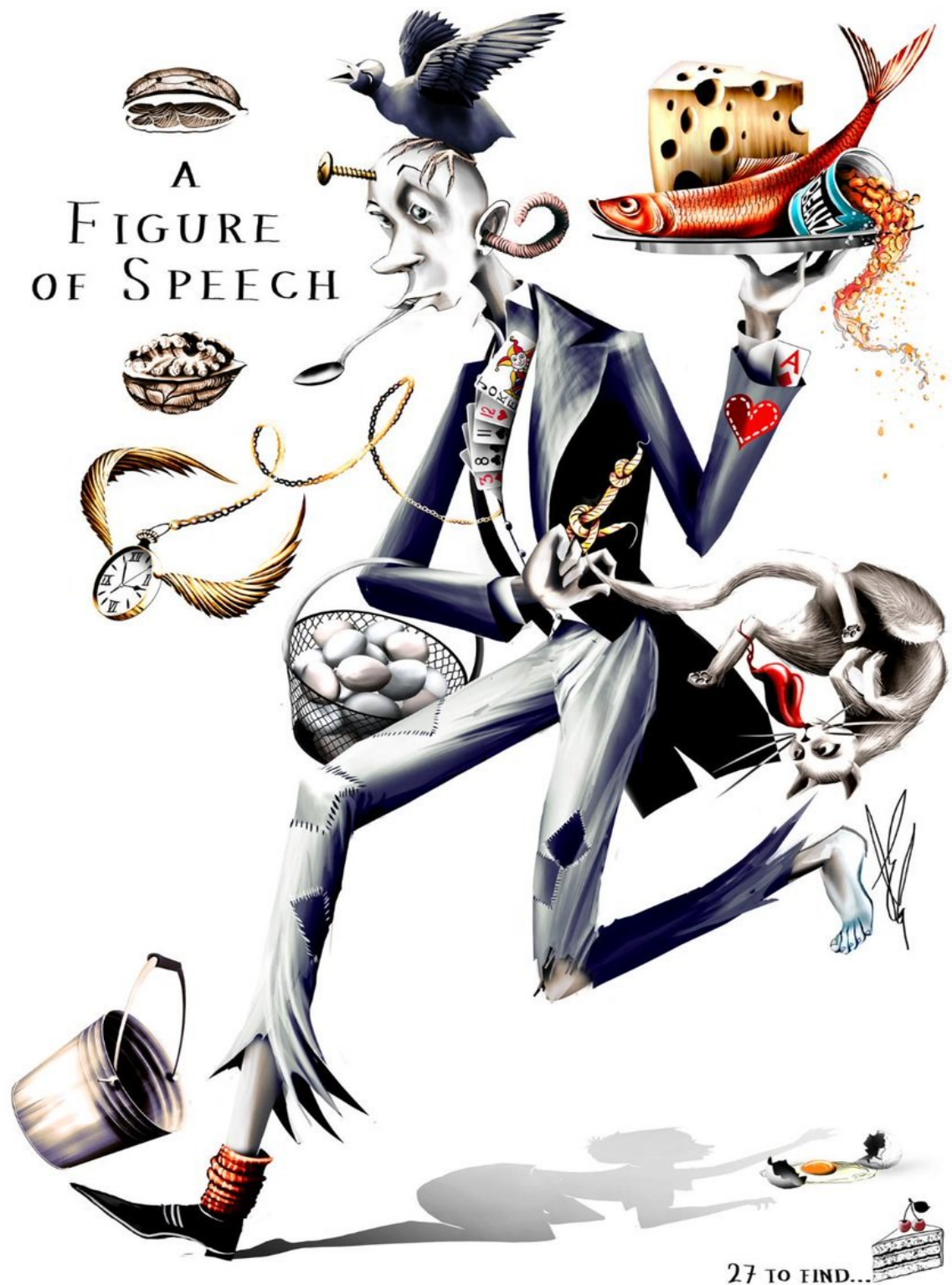

Greetings Brethren

Today is yet another day of our four week (we hope only four weeks) lockdown.

I trust you are all complying with the instructions – stay home, save lives. And if we all play our part, hopefully things can start getting back to “normal” sooner rather than later.

The purpose of this is to suggest a small way in what you, as Lodges, are able to start to assist and check on your Brothers and Widows during this time.

Below is a process which Lodge Whitianga No 443 have set up and we, The Freemasons Charity Management Committee, think each Lodge should consider something similar (if they haven't already!).

We are aware that there are a number of Lodges who have been pro-active and have similar schemes under way already – we thank you for that – this is us re-iterating and supporting all Lodges needing to have something similar in place sooner rather than later.

We suggest each Lodge commences a once a week (or more) telephone calls to each Brother and Widow, which will hopefully keep everybody in touch and informed.

Lodges can set up a number of groups, each with a Group Leader, who is responsible for a number of brethren and widows on the telephone list.

Basically, the Group Leader will make contact and check up on all brethren and those including Widows to place their fortnightly grocery order with their preferred local supplier, and request a home delivery. This is especially important for those over the age of 70 or those who are unwell. It also means that other Lodge members do not have to visit the supermarket for them which reduces everyone's chances of possibly being contaminated.

However, we understand at present there is about a six day wait for grocery delivery which may not be suitable to all – in these instances, it is suggested that once the order has been placed, the Group Leader (or someone else nominated), collects the groceries for the Brother or Widow and delivers it to the door step. Remember, we only want a small number of people doing this, which lessens the risk to all.

We are also aware that there will be some brethren or Widows who are unable to activate this type of ordering. In this case, the Group Leader can place the order for the Brother or Widow, pay for the shopping through the Lodge account and then the Brother or Widow reimburses the Lodge.

If a Brother or Widow is advised that delivery is held up or is of an unacceptable delay, they then phone the Group leader – who will arrange for someone to collect and deliver it.

This process is great, and again, one we think each Lodge should put in place as soon as possible, if they haven't already.

We thank you all for your support, compassion, time and effort during this unprecedented time.

Should you have any questions, please contact the Charity Administrator, Shelley Newson, on 04 3855748.

