

# NEW ZEALAND Freemason

Issue 1 (Vol. 53), March 2025

## New Zealand's Newest Lodge

*Aurora Lodge No 477 – A new dawn*

Grand Installation 2025  
*coming soon...*



[www.freemasons.nz.org](http://www.freemasons.nz.org)





# Freedom to enjoy your retirement

Heartland Reverse Mortgages have helped over 23,000 Kiwis live a more comfortable retirement. A reverse mortgage could help you access equity in your home without having to move.

You could use a reverse mortgage for a number of purposes including home improvements, assisting family, medical and healthcare, purchasing a new car, day to day living expenses or unexpected costs. Enjoy considerable flexibility and protection including:



Maintain ownership of your home



Flexible drawdown options



No regular payments required



Designed to provide you peace of mind

Call our friendly dedicated team today to discuss how a reverse mortgage could help you on **0800 488 740**.

A special fee discount has been negotiated for Freemasons members, please enquire with our Reverse Mortgage Specialists. Heartland Bank Limited's responsible lending criteria, fees and charges apply.



**FREEMASONS**  
New Zealand

**HEARTLAND**  
BANK

# In this issue

From the Editor **2**

Hot Off the Press **3**

Grand Master's Visits **3**

From the Grand Master **4**

News clips **6**

From the Executive Director **8**

## MAKING A DIFFERENCE IN NEW ZEALAND

Triple 2<sup>nd</sup> Degree – Celebrating the spirit of country Lodges **10**

Grand Installation & Communication 2025 **11**

100 Years of Lodge Haeata in Hastings **12**

Freemasons and Auckland Round the Bays 2025  
A real masonic family day **13**

A cracker start to the Masonic year in Napier **14**

New Junior Grand Warden invested **15**

A grand finish to 2024 in Hutt Wairarapa District **16**

First New Zealand Masonic Meeting in 2025 **16**

140 Years not out! **17**

Freemasons support Relay for Hope in Marlborough **17**

Hutt Valley Freemasons help with food **18**

Freemasons Tin and Toy Run for kids and families **18**

Freemasons support for Community Patrol **19**

New Divisional Grand Almoner – Central **19**

Triple win for Eastern Auckland Women's Refuge **20**

Canterbury West Coast Air Rescue Trust **20**

Anna Elliot – World Olympic Gymnastics Academy **21**

Two 'Brothers' from different Mothers **22**

Kiwi Freemasons go to the Far West **22**

United Grand Lodge of Queensland, Grand Installation, Brisbane **23**

Fire Safety **24**

Elder Care is a cornerstone of Freemasonry **26**

We should always remember the Widows **27**

Another 70-year Freemason **27**

Potter Trust **28**

## MASONIC EDUCATION

Discovering Freemasonry: The Treasurer **30**

Discovering Freemasonry: The Secretary **30**

What is the Copestone (or Capstone) and what is its connection to Craft Masonry? **31**

On Masonic Leadership (and what you need to know) **31**

Freemasons Foundation **32**

A New Zealand DeMolay Renaissance: Building Men of Character in the Land of the Long White Cloud **34**

One Year To Go Until the Special Olympics NZ National Summer Games! **35**

## THE FREEMASONS CHARITY

Less litter, thanks to the Freemasons **36**

Sailing Away! **37**

The Freemasons Charity Paramedicine Scholarship **37**

New Zealand's newest Lodge **38**

Masonic Villages Trust **40**

CCS Disability Action **42**

Royal Arch **43**

First Steps **45**

Welcome to our newest Freemasons **47**

The Last Word! **48**

Service Awards **49**



## Making a difference in New Zealand

## FREEMASONS NEW ZEALAND

National Office  
Unit 2, 22 Tacy Street  
Kilbirnie, Wellington 6022  
PO Box 6439, Marion Square  
Wellington 6141  
New Zealand

Ph: +64 4 385 6622

Email: [membership@freemasons.org](mailto:membership@freemasons.org)

[communications@freemasons.org](mailto:communications@freemasons.org)

[www.freemasons.org](http://www.freemasons.org)



The *New Zealand Freemason* is the official journal of the Grand Lodge of Free and Accepted Masons of New Zealand. Unless otherwise indicated, the opinions expressed and the advertising content are those of the authors and do not necessarily reflect the policy of Grand Lodge.

Articles appearing in this journal may be reproduced without permission provided acknowledgement of the source is made and a copy of the publication is forwarded to the Grand Secretary ([secretary@freemasons.org](mailto:secretary@freemasons.org)).

Queries or comments regarding subscription or distribution should be addressed to [membership@freemasons.org](mailto:membership@freemasons.org) or the Grand Secretary, PO Box 6439, Marion Square, Wellington 6141. Queries and comments regarding content and advertising should be addressed to the Editor.

Contributions to the magazine, preferably in electronic form (e.g. MS Word documents) are greatly appreciated and should be of interest to a wide audience. Photographs should be high quality, preferably in jpg or tif format. Contributions may be edited in order to fit space available and to achieve overall balance. Letters to the Editor should not exceed 300 words. A guidance sheet for preparation of publishable material is available on request from the Editor. Contributions should be forwarded to [communications@freemasons.org](mailto:communications@freemasons.org)

Freemasons NZ contributions to Duane Williams, Editor  
[communications@freemasons.org](mailto:communications@freemasons.org)

Royal Arch contributions to Duane Williams, Editor  
[gsn@royalarch.org.nz](mailto:gsn@royalarch.org.nz)

**Magazines are distributed in March, June, September and December. The deadlines for contributions are the first day of February, May, August and November**

Layout by Bartlett Projects, Wellington

Printed by Fisher Print Ltd, Auckland

Copyright © 2025 Freemasons NZ

## ADVERTISING RATES PER ISSUE

| Description            | Height | Width | Base price | Discounted (4 Issues) |
|------------------------|--------|-------|------------|-----------------------|
| Full page              | 240mm  | 175mm | \$1250     | \$1000                |
| Half page (vertical)   | 240mm  | 85mm  | \$650      | \$500                 |
| Half page (horizontal) | 120mm  | 175mm | \$650      | \$500                 |
| Banner                 | 75mm   | 175mm | \$350      | \$250                 |
| Quarter page           | 120mm  | 85mm  | \$350      | \$250                 |

All figures GST exclusive. For full advertising details contact [communications@freemasons.org](mailto:communications@freemasons.org)

## From the Editor

### The Grand Lodge of New Zealand – we are all members

We are all members of The Grand Lodge of New Zealand, which only usually meets at Special or Annual Communications or the Grand Communication and the Grand Installation.

Between this, it requires Freemasons to help manage aspects of the organisation at a Lodge, District (Region), Division and Nationally.

Lodges use the Officer Ladder process to fill the roles within a Lodge with occasional exceptions, usually on an annual basis.

Triennially, we seek nominations to assist with roles at a District (Region), Division and National level. Every position from Grand Tyler to Grand Master, to Board Directors/ Grand Lodge Trustees and as required Board Committee members.

If you think you have the skills, ability, time and the enthusiasm to fill any of these roles, it is a great way to step up and help your organisation – Freemasons New Zealand.

All the details can be found here  
[freemasons.org/2025-communication](http://freemasons.org/2025-communication)

It is important as a member of The Grand Lodge of New Zealand that you try to attend Communications and Grand Installations.

Grand Installations are a time for celebration and lots of fun for members and partners, and again well worth the effort for a great weekend away and seeing an Installation like no other.

It is being held over Labour Weekend in Christchurch on 24–26 October 2025 at the James Hay Theatre in the Christchurch Town Hall and Te Pae Conference Centre with the Crowne Plaza Hotel (being the preferred Hotel) within walking distance of both venues.

All details can be found here [freemasons.org/2025-grand-installation-and-grand-communication](http://freemasons.org/2025-grand-installation-and-grand-communication)

With Registration, Events and Hotel Discount Code up very shortly.

Let's support our Southern Brethren who are going all out to give you a great Grand Installation and associated events.

RWBro Duane Williams MBE, KCLJ, JP, PGW and GSec



Grand Installation 2022.

# HOT OFF THE PRESS

## New and Young Masons Forum – Workshop and Meeting

Our Grand Master, Jim Watt, established this group in his speech at the 2022 Grand Installation.

Ian Hunt, Senior Grand Warden, has been their facilitator and has had several Zoom Meetings with the team, but they were brought together for a two-day face-to-face meeting at the National Office recently.

Several Presenters had sessions on the current Masonic

Transformation, Freemasons Charities, Growth, Outreach and Membership, Ceremonial, Masonica App, Ask the Grand Secretary, Education and

their own NYMF Meeting with discussion topics and successes.

Our Grand Master, Jim Watt, attended both the opening and closing.

Encouraging them to continue to provide a younger perspective on Freemasonry.

### NYMF attendees

Lawrence Levine, Robert Ford, Elliot Tuck, Brady Whale, Gareth Far, Danny Blackman, Bill Busfield, Sam Williams, Leon Daziel, Ben Payne. Along with our Grand Master, Jim Watt, Ian Hunt, Senior Grand Warden and Facilitator, and Ainsley Watson, the last presenter – in no particular order.



## GRAND MASTER'S VISITS

**18 Feb** Scinde Lodge No 5, Investiture of Senior Grand Warden and Double 1<sup>st</sup> Degree, Napier Freemasons Centre

**25 Feb** Lodge Aorangi Timaru No 196, Investiture of Junior Grand Warden and Presentation of Lady Almoner Appreciation Certificates at Timaru Freemasons Centre.

**1 Mar** Grand Lodge of Scotland, District South Island NZ, Installation of District Grand Master by Grand Master Mason at Dunedin Freemasons Centre by MW Bro Graham Wrigley Past Grand Master on behalf of MW Bro Jim Watt Grand Master.

**5 Mar** Lodge Wanaka No 277, Centennial Celebrations and 2<sup>nd</sup> Degree at Wanka Freemasons Centre.

**8 Mar** Grand Lodge of Scotland, District North Island NZ, Installation of District Grand Master by Grand Master Mason at Airedale Street Masonic Centre, Auckland.

**7-8 Mar** Supreme Grand Royal Arch Chapter of New Zealand, Grand Convocation (Installation) by MW Bro Graham Wrigley, Past Grand Master on behalf of our Grand Master MW Bro Jim Watt.

**15 Mar** The Lodge of the Liberal Arts No 550, Installation of WBro Cameron Smith (Chair of Property and Insurance Committee), Ellerslie Masonic Centre, Auckland.

**21-24 Mar** Grand Installation of the United Grand Lodge of Victoria, Melbourne with his New Zealand delegation.

**5 Apr** Dedication of the Palmerston North masonic Centre, Amesbury Street, Palmerston North and 60 Year Bar for RW Bro Arnold Bloxham P Prov GM.

**7 Apr** The Caledonia Lodge No 15, 60 Year Bar W Bro John Poland, Timaru Freemasons Centre.

**16 Apr** Lodge Nelson No 288, 1<sup>st</sup> Degree, Nelson Tasman Freemasons Centre.

**24-26 Apr** Grand Installation (ANCOM2025) for The Grand Lodge of the Philippines, Manila, Philippines accompanied by the Deputy Grand Master.



# FROM THE GRAND MASTER

## The True Lodge: Beyond Brick and Mortar

For centuries, Freemasonry has been a beacon of fraternity, enlightenment, and service to our communities. When we think of a Masonic lodge, it is natural to picture our buildings, some of which have stood for generations—some quite grand and adorned with ornate architecture, others humbler but no less significant. However, it is crucial to remind ourselves that a Masonic lodge is not the building in which we gather. It is the collective spirit of the brethren who meet within its walls.

### A Lodge is its People, Not its Premises

Brethren it is time to rethink our attachment to our properties and the misconception that our buildings are our Lodge. The heart of Freemasonry is the shared bond between brothers, the commitment to personal growth, and the dedication to charity and service. It is not the structure that defines us, but rather the unity and fellowship we cultivate and live. The lodge room may host our ceremonies, but it is our actions that bring our Masonic principles to life.

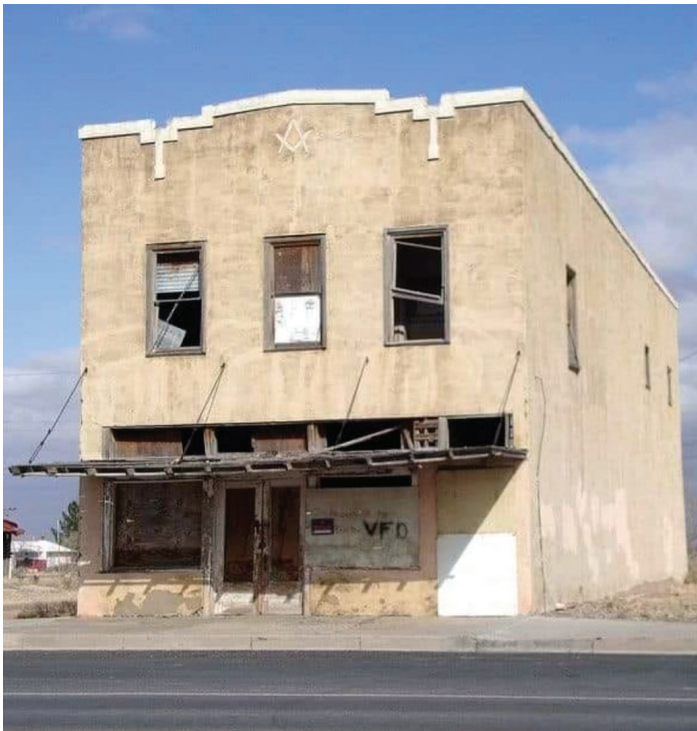

This perspective is particularly important as we face the harsh reality of our Masonic infrastructure. Many, if not nearly all of our buildings, do not meet current earthquake standards, have suffered from years of deferred maintenance. Their outdated facilities struggle to meet modern safety and accessibility standards and the owners of these buildings and/or the Lodge Trustees should be aware that they could personally be held liable should someone be injured or worse. These same buildings that once symbolised our strength now stand as reminders of a challenge we can no longer afford to ignore.

### The Burden of Maintenance and Declining Membership

For too long, we have maintained a mindset that equates our lodges with the physical spaces they occupy. This has led to a reluctance to part with buildings that have become financial burdens. The reality is that many of our meeting places now require significant investment to remain safe and functional. With membership numbers not what they once were, the financial strain of upkeep falls on fewer shoulders.

Compounding this issue is the fact that membership dues have remained relatively low for decades. While the cost of living has



generations, we must shift our focus from preserving buildings to preserving the essence of our craft. This means embracing new ways of gathering, including shared spaces and rental facilities. It also means having honest conversations about the financial sustainability of our current model and being willing to make difficult but necessary decisions.

Letting go of a cherished lodge building is never easy, but it is sometimes the wisest course of action. Selling or repurposing underutilised properties can provide much-needed funds to invest in the future of our fraternity. More importantly, it allows us to direct our attention back to what truly matters: strengthening our brotherhood, engaging with our communities, and living by our Masonic principles.

## Moving Forward with Purpose

Freemasonry has endured for centuries not because of the buildings we have occupied, but because of the men who have carried its torch forward. As we face the reality of aging infrastructure and changing demographics, we must reaffirm that our true lodge is not made of stone and wood, but of dedication and brotherhood.

By making thoughtful, strategic decisions today, we can ensure that Freemasonry remains vibrant and relevant for generations to come. The time has come to ask ourselves: Are we willing to let go of the unnecessary burdens of the past so we can build a stronger future? The answer must be a resounding yes, for it is only through adaptation and commitment that we can continue to uphold the timeless values of our fraternity.

Brethren, let us remember—our lodge is not where we meet, but who we are when we meet. The true legacy of Freemasonry will never be written in stone, but in the hearts and minds of those who carry its principles forward.

**MWBro Jim Watt**  
Grand Master

risen, our dues have often stayed stagnant, leaving little room for major repairs or upgrades. The result? Many lodges are now left with crumbling buildings that

demand more resources than we can justify.

### Rethinking Our Approach

If we are to sustain Freemasonry for future



# News clips

## Who's Birthday is it next month?

Who is 135 years old this 29th April 2025, here in New Zealand?



The Grand Lodge of Antient, Free and Accepted Masons of New Zealand – The Grand Lodge of New Zealand – Freemasons New Zealand.

Our Grand Lodge was constituted in 1890 on the 29th of April in Christchurch, New Zealand and our first Grand Master was MW Bro Henry Thomson. We were originally formed from Lodges of the English, Scottish and Irish

Constitutions in New Zealand at that time and progressively constituted our own Lodges in the decades since. Recognised Freemasonry arrived in the 1840s. We currently have 174 Lodges and around 4700 members some of whom hold dual membership of Lodges. We are a recognised Grand Lodge in the World of Freemasonry.



Future *New Zealand Freemason* magazines will feature articles on our 135 years as we celebrate our past and look excitedly to the future.

## Masonic Number Plate surrounds for Charity

Don't Miss Out – Support Our Fundraiser Today!

Brethren, our licence plate surround fundraiser is in full swing, and we need your support to make it a success!

Choose from two stunning designs:

- ♦ **Standard Design:**  
Featuring the iconic double square and compasses.
- ♦ **Royal Arch Design:**  
Featuring the square and compasses alongside the triple tau.

By purchasing this item, you're doing more than just upgrading your vehicle's

**Proud to support, proud to display - get your Freemasons number plate surround today for just \$20 and drive change for prostate cancer awareness!**

At the bottom of the advertisement are logos for Freemasons New Zealand, The Freemasons Charity, Prostate Cancer Foundation NZ, and a QR code.

look – you're helping us raise funds for the Prostate Cancer Foundation. Every dollar from this fundraiser supports research, treatment programs, and awareness initiatives to combat prostate cancer, a leading health issue for men worldwide.

**Order Now**

<https://bit.ly/fnz-plates>

Thank you to everyone who has supported us so far—your contributions are making a difference.

WaikatoNewAndYoungMasons@gmail.com







# Leaders eat Last – A provocation of thought, action and outcomes



Executive Director Andrew Cowie.

I normally read books around personal development topics and the world of business and innovation. When I finished at my previous job before coming to Freemasons NZ, I was gifted a book called *Leaders Eat Last* by Simon Sinek which I had not seen before, but codified for business those rituals that I and many other ex-military people practice.

I thought about examples of where I have seen this not being practiced and actually

more from the application of “tradition” and “it’s always been done this way”. Some of us will recognise the past history of “hazing rituals” etc and their tacit but ill-advised and inappropriate approval.

This book is all about leadership and how to be a better leader. The title comes from the United States Marine Corps where the highest-ranking officer of the group always eats last when it comes to mealtime. This is so that they make sure that the people who are

working for the leader are in the best shape and that they get enough to eat.

Despite the concept being referenced as coming from the military, it is a practice that is not common in general business in New Zealand. It is simple to demonstrate this leadership quality in the modern business world to make us successful, and more productive teams.

Here I have a very stark example of it not being put into action or practised.

A couple of years ago I was away for a school rowing camp with my eldest son and as part of that experience, we were all billeted together in a club’s premises not far from the venue. This accommodation required that we communally cook breakfast and make lunches and then given the long days of the competition had contracted catering to provide the hot dinners.

It was all going swimmingly well until the second night when one of the senior teams and their coach arrived back at camp sometime after the main

bus load of rowers and just in time to join the queue for dinner service which has just started.

There was a bit of a commotion as the coach (a previous MAADI medallist) and his team pushed through the queue lines to be at the front to get the fresh hot food to the point whereby the coach was the very first person to get the dinner and followed by the boat captain and rest of the crew.

I was taken aback at this and asked another adult what the story was as perhaps that team had to be back on the water after dinner, but no it was put to me as being “Senior Privilege” ie entitlement that was being reinforced by the coach and the boat captain.

What has this to do with the business of freemasonry or the business of running the business you ask? Great Question.

It is right that in organisations with tradition and history such as ours that at certain times, rank has deference accorded to it, but perhaps it should only be at those times and situations.

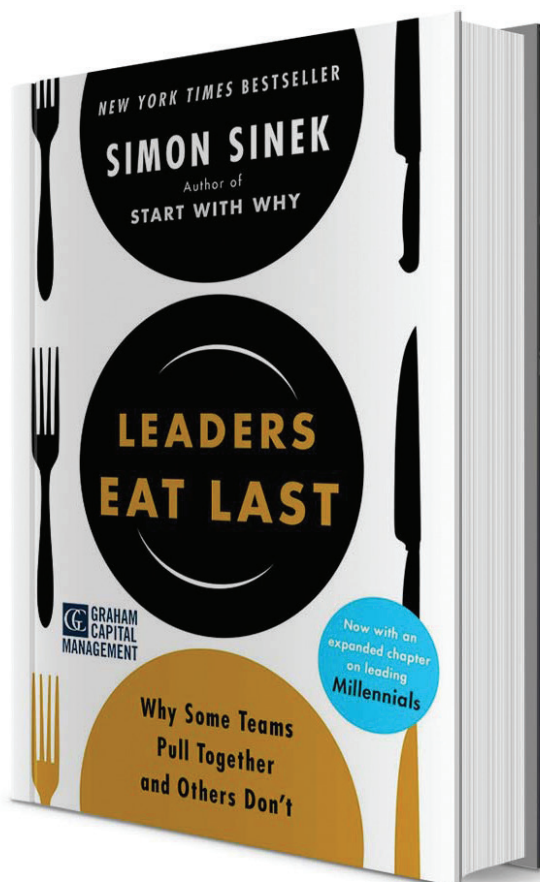

When it is not the right time or place, we might strive to turn the rank pyramid on its head and put those who are newest, youngest, ready, willing and able to the fore and instead take a back seat to support them to be the best contributor they can be to grow the organisation.

For those of us who find ourselves in the longer serving ranks, there are key things for us to do to support such as mentoring in a role of position handover (think Master and the Immediate Past Master construct), supporting those who are new to the workplace, lodge, role.

Freely given and sought out counsel and experience are attributes of those who have been involved for some time and given in the right and authentic intent that is never negative. This is the attribute of a leader who is ensuring that those who come next are prepared to be even better than they are.

The organisation has recently concluded the foundational reset and rightsizing of governance and operations. This has



sparked many a conversation both positive and negative around the brethren.

As we move towards Grand Installation and the transition period, its important that the melding of new and old ideas is embraced.

There is room for all – more importantly there is room for attracting members to the organisation where they can see that tradition and change embrace each

other for the betterment of all.

There are four key takeaways to keep close to hand if you don't get to read the book. Where the word "team" is employed consider substituting it for lodge, brethren, family, organisation.

1. "Leaders eat last" means that leaders first take care of their people, and only after they can think of themselves

2. A team can only effectively face external threats when there are no internal threats, and it's up to leaders to eliminate internal threats
3. Leaders enjoy benefits but must fulfil their responsibilities too (protecting the tribe)
4. We need more leaders, so take it upon yourself to become one.

**WBro Andrew Cowie**  
Executive Director



## Making a difference in New Zealand

# Making a difference in New Zealand



## Triple 2<sup>nd</sup> Degree – Celebrating the spirit of country Lodges

Creating memorable, life changing ceremonies for candidates remains the very best way to turn our organisation around. And so it was at Waihenga St Mark's Lodge No. 37 in Martinborough at their meeting on October 2.

Over the past 18 months the Lodge has increased its membership by 50% and is now one of New Zealand's largest Lodges. And what do they claim as the 'secret sauce' for their success? 3 things come to mind – making every lodge meeting a truly fun night out; creating life changing experiences for candidates; and great ceremonial and ritual.

On October 2 more than 60 brethren and visitors gathered to witness a triple 2<sup>nd</sup> Degree. According to some reports the last triple degree working in the Lodge was in 1975. Two of the candidates, Mike Sanderson and Phill Dellow came from Empire Fergusson

Lodge No. 225 with the other, Dean Ramos, coming from The Coronation Lodge No. 127, both Lodges in the neighbouring Kapiti-Wellington District.

The ceremony involved Senior Deacons from all 3 Lodges overseeing the perambulations while the Obligation was split into 3 so that each Master could claim some involvement in the ceremony. Some parts of the ceremony were delivered one-on-one but most of the charges involved the candidates responding in unison. The mood of the evening was set early on with all 3 candidates delivering flawless responses to the 1<sup>st</sup> Degree Test Questions.

60 brethren attended the excellent refectory afterwards. The Lodge's caterer had prepared excellent winter fare with roast pork roasted vegetables following by apple and rhubarb crumble. Over 17 Lodges attended and the District Grand Master, VW Bro Steve Griffin was not only in attendance but delivered a remarkable South East corner charge.

Worshipful Master, RW Bro Russell Pratt, PDivGM commented that "...lodges need to take more control of their destiny. You shouldn't be relying on 'Wellington' to fill your Lodge room and drive membership" The Lodges that have the greatest chance of surviving are those that genuinely

strive to turn on a good show, fill the Lodge room and refectory with masons who are having fun and deliver good quality ritual WBro Russ said.

As an added bonus all three of the EV chargers installed at the Lodge Room a few weeks ago were in full use on the day.

A prospective candidate in attendance at refectory can't wait to join on the strength on the fellowship and camaraderie he experienced throughout the evening.

If Freemasonry is to continue to be a positive driving force in New Zealand it is imperative that country Lodges remain at the centre of our DNA. With a little bit of energy and innovation every country lodge has the potential to fill their lodge room and refectory. Grasp the opportunity with both hands.

Photo acknowledgement  
WBro Kieran Crickmar –  
Grand Steward





# Grand Installation & Communication 2025

This is being held from 24 to 26 October 2025 (Labour Weekend) in Christchurch. It will see the Business Session of the Grand Lodge and the Grand Installation of the new Grand Master and his Officers of the Grand Lodge. Venues include the James Hay Theatre at the Christchurch Town Hall, Te Pae Convention Centre and Crowne Plaza as the preferred hotel.

Freemasons and Partners are welcome to attend most of the events:



FRIDAY 24 OCTOBER  
**Grand Communication**  
**Business Session (NZ Freemasons only)**  
**Meet and Greet**



SATURDAY 25 OCTOBER  
**Grand Installation**  
**Grand Banquet**

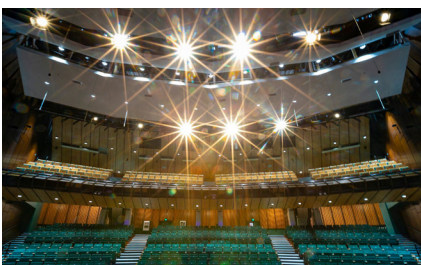

SUNDAY 26 OCTOBER  
**Free day for exploring**  
**the wonders of Christchurch**

Registration, events and accommodation details nearer the time.  
[www.freemasons.nz.org/2025-grand-installation-and-grand-communication](http://www.freemasons.nz.org/2025-grand-installation-and-grand-communication)

# Making a difference in New Zealand

## 100 Years of Lodge Haeata in Hastings

Freemasons New Zealand's Lodge Haeata No 272 in Hastings is celebrating 100 years. Hundreds of men have been members of the Lodge during its long history, and the community has benefited. Since 2010, the Lodge has raised over \$180,321 for local and national charities.

Lodge Haeata was founded in 1924 when 26 men came together after Lodge Heretaunga, the first Hastings masonic lodge, had reached maximum capacity. The founding members came from a wide range of occupations, including being a jeweller, schoolmaster,

stock agent, solicitor, accountant, engineer, printer, ironmonger, outfitter, orchardist, hotel keeper, dentist, and farmer. They all agreed on the name Haeata, a Māori word meaning "an opening in the clouds in the early morning emitting a beam of light."

Some notable Hastings men that have been members of Lodge Haeata include Fred Rush-Munro (founder of Rush Munro's in 1926), Sir Edwin Bate, OBE OStJ (Hastings Mayor 1953-59, Grand Master of The Grand Lodge New Zealand 1972-74, Chair Hawke's Bay Hospital Board 1941-74,

Master of Lodge Haeata 1943) and Mick Thomson (founder of Thomson Suits in 1957)

Charity is a big part of what Freemasons do. \$180,321 has been raised by Lodge Haeata since 2010 with the help from the Freemasons Charity to charitable causes such as Cranford Hospice, Women's Refuge, Hawke's Bay Cancer Society, St John Ambulance, Multiple Sclerosis Society, Parkinsons Society Hawke's Bay, Hastings District Masonic Trust (a trust set up by Freemasons in 1965 which manage nine retirement villages and flats

in Hastings and Waipawa) and many more charities.

Freemasonry's traditions and ceremonies came from the ancient stonemason guilds that built the castles and cathedrals of Europe. The Lodge strives to build good men of strong character and values. Bruce Hastie, who has been a member of the Lodge for 66 years, said: "Freemasonry is a wonderful organisation, and it offers so many great opportunities. I've appreciated the friendships made over the years and the Lodge's 100th celebration is another memory for me".



Oldest member Bruce Hastie, Past District Grand Master and Lodge Master Don Casagranda, cutting the cake, Sir Edwin Bate, Past Grand Master and member of the Lodge, Divisional Grand Master – Central Mick Turner as the Grand Masters' Representative (the Grand Master and Deputy Grand Master being overseas at the time), Foundation Members, Master Speaking, Group Photo at Centenary Celebration.

# Freemasons and Auckland Round the Bays 2025

## *A real masonic family day*

We are excited to share the success of Round the Bays 2025 (Auckland), where Team Freemasons, consisting of about a hundred Freemasons, family, and friends, came together to participate in the event and join the after-match gathering. At the marquee, we enjoyed sizzling sausages, cold drinks, shared stories, and laughter, strengthening our bonds as brethren.

This initiative was led by Titirangi Mt Albert Lodge No. 204, with Carlo Abeleda as Team Captain. His leadership was instrumental in the event's success, not only ensuring a well-organized experience but also achieving our fundraising goal of \$1,000 for The Freemasons Charity through the sale of team shirts. This donation was proudly presented at the marquee to the Divisional Almoner – Northern, Geoff Parry.

Through this event, we have demonstrated that Freemasonry fosters strong fellowship by bringing men

together in a spirit of unity. We have also shown how our compassion extends into charity, helping us build a positive community profile through Freemasons Charity. Furthermore, this event reinforced that Freemasonry cultivates leadership growth—both within and beyond the lodge. And also providing an enjoyable and respectful environment for our Masonic family.

The brethren were truly energized by the experience and are already looking forward to Round the Bays 2026!

Lastly, we extend our sincere gratitude to Grand Lodge for their unwavering support, particularly to John Lukaszewicz (Northern Divisional Grand Master), Andrew Alexander (Auckland District Grand Master), Jeff Mear (Grand Almoner), Mark Pagulayan District Grand Director of Ceremonies and many others. Without their support and assistance, this event would not have been such a tremendous success.

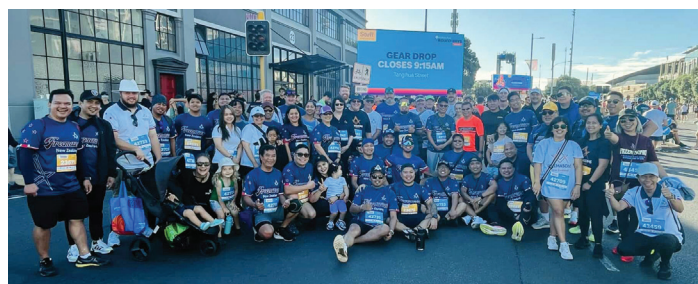

# Making a difference in New Zealand

## A cracker start to the Masonic year in Napier

Our Grand Master, Jim Watt attended Scinde Lodge No 5 in Napier for a double first degree and his investiture of his new Senior Grand Warden.

Abel Esteban and Graeme Austin were initiated as Entered Apprentice Freemasons in a double first (and the lodge has many new members waiting on their programme in 2025).



Brothers Esteban and Austin.

We welcome these two new members to Freemasons New Zealand.

Our Grand Master also invested Ian Hunt as Senior Grand Warden (previously Junior Grand Warden) on the night. He travels to Timaru next week to invest in Paul Johnston as Junior Grand Warden. These promotions are a consequence of the sad passing of Ian Musgrove SGW.



RWBro Ian Hunt being invested as Senior Grand Warden, Grand Master and departure of Grand Lodge.



# New Junior Grand Warden invested

Our Grand Master, Jim Watt, accompanied by the Deputy Grand Master Paul Chappel, went to Lodge Aorangi Timaru No 196 at the Timaru Freemasons Centre recently to invest RW Bro Paul Johnston as Junior

Grand Warden after the sad passing of Ian Musgrove and the promotion of Ian Hunt to Senior Grand Warden.

He was pleased to present two ladies, Mrs Pam Miller and Mrs Bev Dryden, who assist the Lodge

Almoner with Certificates of Appreciation for their hard work over several years.

Eoin Dryden Past Grand Director of Ceremonies presented the First Degree Tracing Board to two Fellowcrafts, who received

masonic lapel pins from the Grand Master in the masonic part of the meeting.

The Caledonian Lodge No 16 provided stewards for the night.



Grand Master investing Paul Johnston as Junior Grand Warden, Lady Almoners with Appreciation Certificates, Grand Master meeting visiting Masters, Grand Master meeting the Ladies, Refectory and Stewards.

# Making a difference in New Zealand

## A grand finish to 2024 in Hutt Wairarapa District

Mid-December saw Officers of Grand Lodge perform a second degree working on a candidate from Lodge Mangaroa No 419 at the Upper Hutt Freemasons Centre in Trentham. Previously in the Hutt-Wairarapa District, a Grand Lodge working, was carried out at the Stokes

Valley Lodge immediately after a Grand Installation, with the new District team holding the office of Master (District GM), Senior Warden (GS), Junior Warden (GS) and DC (Dist GDC), with the other GS's being a Deacons. This then became a yearly event with the District team holding a ceremony up until

Stokes Valley No 460 handed in its charter.

A proposed Grand Lodge working was being organised in 2023, but with the passing of the previous District Grand Director of Ceremonies, Late Brian Green, on the 28th November, the working was postponed. The current

District Grand Director of Ceremonies TR (Mac) McKenzie arranged with the Master of Lodge Mangaroa to carry out a second degree working on Brother Wael Khan, a candidate from Lodge Mangaroa.

A total of seventeen Grand Lodge Officers took part in the ceremony of the perambulations, charges and Lodge Officers. This was nearly all of the 20 Grand Lodge Officers in attendance, which outnumbered the regular members and visitors.



Pictured are the Grand Lodge Officers present at the working together with the Worshipful Master, Tony Fryer (red bow tie) and Brother Khan FCF (centre of picture).

## First New Zealand Masonic Meeting in 2025

The First Masonic Meeting for 2025 in Methven in Mid-Canterbury was held at The Methven Lodge No 51 on 8th January 2025 again hosted the Combined Lodges Inter-District Meeting with United Forces Lodge No 245 and St Augustine Lodge No 99.

The second Degree was conferred on Bro Angelito Ingan EA from St Augustine Lodge No 99 in Waimate. He was supported by 50 Freemasons in what is usually our Masonic Summer break.

The work was carried out by all three Lodges and these blended in well together, with a daily advancement in masonic education, with the different lodges customs.

Also in attendance was a Master Master from the Grand Lodge of the Philippines who hopes to be residing permanently in New Zealand. He wore a traditional Filipino barong and a white apron which is worn differently to denote rank – Entered Apprentice – no flap, Fellowcraft – Flap

up and Master Mason – Flap down.

A wonderful masonic kickstart for Lodges in Canterbury, Mid-Canterbury and South Canterbury.



# 140 Years not out!

The Te Aroha Lodge No 52 has celebrated its 140th Anniversary, having started as a Scottish Constitution Lodge in 1884, and joining The Grand Lodge of New Zealand in 1890.

"Te Aroha" is a Māori phrase that means "the loved one" or "the mountain of love". "Te Aroha is derived from the name of Mount Te Aroha, which comes from the phrase "Te Aroha-a-uta".

"Te Aroha-a-uta" translates to "love flowing inland". It is also the name of the town that the Lodge was originally based in, now they are in Morrinsville in the Waikato, New Zealand.

Our Deputy Grand Master, Paul Chappel was present as a member. It is his Mother Lodge.



Bob Monson Past Grand Almoner cutting the 140th Cake, the Piper for the Haggis, as a nod to the lodge's original Scottish heritage, including Neeps and Tatties, the cake, and the Refectory with a large number of Freemasons and Visitors for this important milestone in the Lodge's history.

## Freemasons support Relay for Hope in Marlborough

We are absolutely thrilled to announce our naming sponsor for the 2025 Relay For Life event Freemasons New Zealand Nelson Marlborough Freemasons Charity and Combined Lodges.

Our original goal for this year was to have 40 teams, and we're beyond excited to share that we have now reached 52 teams! Thank you to everyone for your incredible support and commitment – we can't wait to see you all there!

When: 4pm Saturday 22nd March – 8am Sunday 23rd March

Where: Lansdowne Park  
Address: 6 Lansdowne Street, Mayfield

Don't miss out on being part of this amazing community event! Standard ticket pricing closes on March 16th, 2025, so make sure to register now [relayforlife.org.nz/o/2025-marlborough-relay](https://relayforlife.org.nz/o/2025-marlborough-relay)

# Making a difference in New Zealand

## Hutt Valley Freemasons help with food

Stokes Valley Food Bank was assisted by Lodge Te Puni No 315 (via their connection with the former Stokes Valley Lodge No 460) and The

Freemasons Charity, which provided \$1500 for Food Vouchers. Lodge Mangaroa No 419, Trentham Lodge No 262,

and The Freemasons Charity support the Upper Hutt Women's Centre with \$1800 grocery gift cards.

Much needed help for many during a busy and stressful festive season.



## Freemasons Tin and Toy Run for kids and families

The Wellington Chapter of the Widows Sons (our Masonic Motorcyclists), organised its Annual Tin and Toy Run, they supported the Salvation Army with Toys and a further Donation of

\$2000, and the Downtown Community Ministry (DCM) with Food and a further Donation of \$2000, thanks to all the participants and with a top-up from The Freemasons Charity.



The Coronation Lodge No 127 helped feed the participants with BBQ fare at the beginning of their fundraising ride.

Goodwill and Cheer during the festive end of the year.

## Freemasons support for Community Patrol

When Stuart Campbell, current Master of the Nau Mai Lodge No 177 in the Waikato District of Freemasons New Zealand suggested the donation of fire extinguishers to the local community patrol, it was through his own personal experience. As head of North Hamilton Community Patrol in the 2000s, he pushed for the patrol to acquire larger fire extinguishers to be carried by the patrol in case they had to assist at a fire. Consequently, a patrol came across a car on fire, and the young female driver was trapped inside. Fortunately, with the extinguisher, the patroller was able to push back the fire long enough to extricate the injured driver from the car before it was engulfed in flames, saving the driver's life. Subsequently, the patroller received a commendation for his actions.

With this in mind, members of Nau Mai

Lodge presented two 2.5kg fire extinguishers to Eric Walker and Police Senior Constable Peter Marks of the Taumarunui Community Patrol group. This is in the hope that should any such situation come about, the patrol would be equipped to assist until more help could arrive. However, only if this could be done safely.

It can't be understated, the role that Community Patrol plays in keeping our towns safe. The members of this organisation assist as extra eyes and ears for the police around our community. They are not vigilantes and do not directly involve themselves in situations where potential criminal activity may be taking place, but always remain at a safe distance.

Another connection to Nau Mai Lodge and Community Patrols is one of its past Masters-Ron Rhodes. Ron was instrumental in establishing not only the first



Nau Mai Freemasons present the extinguishers to Taumarunui Community Patrol.

community patrol in New Zealand, formally known as Night Owls, but went on to establish the nationwide organisation with over 150 affiliated Community Patrols throughout New Zealand.

Taumarunui Community Patrol is looking for volunteers to assist Police with an extra set of eyes on patrol. All patrollers are police vetted and

undergo training. Anyone interested in joining the local Community Patrol team, please contact Louise at [taumarunui@cpnz.org.nz](mailto:taumarunui@cpnz.org.nz) or Senior Constable Peter Marks at the Taumarunui Police Station.

For more information on what Community Patrol is all about, check out our Facebook page, "Taumarunui Community Patrol".

## New Divisional Grand Almoner – Central

Charity is one of the cornerstones of Freemasonry.

The new Divisional Grand Almoner for Central Division VW Bro Craig Ancell (accompanied by Tracy), was invested by our Grand Master, MW Bro Jim Watt, at The St Andrews Kilwinning Lodge No 79 in Whanganui. Accompanied by Paul

Chappel, Deputy Grand Master, and Jeff Mear, Grand Almoner.

Two of the previous Divisional Grand Almoners, Adrian Douglas, Past Divisional Grand Almoner and Mike Kendrick, now Past Grand Warden, were present. Both of whom were thanked for their efforts over the last several years.

Entered Apprentice Freemason Julian Chevalier was presented with a Square and Compasses Lapel Badge by the Grand Master.

It was followed by a Burns Night with an Address to the Haggis and the enjoyable company of the Ladies.



Craig being invested by our Grand Master and present and past Almoners (Grand or Divisional).

# Making a difference in New Zealand

## Triple win for Eastern Auckland Women's Refuge

Lodge Howick No 314 with assistance from Howick and Districts Charitable Trust and The Freemasons Charity donated \$3082.00 for combination locks to be fitted to bedrooms at the Refuge to add extra personal security for women including dependents.

In the final quarter of the year, Howick Lodge made a significant contribution to the Eastern Women's Refuge, providing much-needed support to upgrade the security of their Safe House.

Since 1987, the Eastern Women's Refuge has been

dedicated to helping women and children in Southeast Auckland who are victims of domestic violence. The organisation offers a wide array of services, including assistance with accessing healthcare and counselling, budgeting advice, help with protection orders and legal matters, securing housing, funding for children's activities, and providing essentials such as food and clothing.

Ana Atkinson, the Refuge's Community Engagement Lead, explained that the Safe House had been in desperate need of a security overhaul for some time. Unfortunately, due to limited funding, other urgent priorities had to take precedence. "We are deeply

grateful to the Freemasons for their generous support in making this upgrade possible," says Ana. "This enhancement will provide a greater sense of safety for the women and children staying with us. We are thrilled to be one of the recipients of Freemasons' support and look forward to the possibility of a long-lasting partnership."

The Lodge is also working with 'East Auckland Bellyful' Charity to supply meals to those who require them at the Refuge and 'I got your Back Packs' Charity with basics in a backpack, at the Refuge, for those fleeing domestic violence (both charities previously assisted by Freemasons).

Kerry Otto – Lodge Almoner, Ana (Women's Refuge Community Engagement Lead) Robert Welcome Auckland District Charity Officer.



## Canterbury West Coast Air Rescue Trust

Late last year a District project was completed by Lodge Aorangi Timaru No 196 and, as a result of this campaign, the Lodge donated \$65000 to the Air Rescue Trust.

The funds resulted from donations from the Sophia Street Car Park Charitable

Trust, The Midland Masonic Charitable Trust, District Lodges and one brother. The Freemasons Charity then stepped in with a \$2 for \$1 subsidy totalling \$44000.

The Lodge is indebted to V W Bro Jeff Elston, District Almoner, for the immense

amount of work he put into the application.

The grant came after RWBro Paul Johnston took MWBro Jim Watt, Grand Master, and RW Bro Jeff Mear, Grand Almoner to visit the car park operation while they were attending the Southern Division conference in August 2024.

On Friday, 7 February, a visit was made to the Air Rescue base, at Christchurch Airport, by R W Bro Mear, and his wife Yvette, R W Bro Johnston, his granddaughter Levi Watson and great grandson Raiden Bennett. They were given an extensive tour of the facility and the operation being run there in conjunction with

Garden City Helicopters. Raiden was transported to Christchurch at age 16 days, by rescue helicopter, three years ago.

Mrs Christine Prince, CEO of the Air Rescue Trust, and Mr Adrian Hurst, a critical care paramedic, led the tour. We were also shown the aircraft operated by the NZ Flying Doctor Service, which is a sister trust to the CWCART, which flies very regularly to Auckland on hospital transfers.

The visit took about an hour and a half and was most beneficial to us, and RWBro Mear to get an understanding on how the service works.



FROM LEFT Ed Fry, Rescue Pilot; Mrs Christine Prince, CEO of the Air Rescue Trust; RWBro Jeff Mear, Grand Almoner. Note the Freemasons Square and Compass on the fuselage

## Anna Elliot – World Olympic Gymnastics Academy

Anna Elliot was supported by the Wellington Masonic Youth Trust and Lodge Zetland No 312.

Anna was chosen in the Wellington Region contingent to represent New Zealand in the World Olympic Gymnastics Academy for women's artistic gymnastics that are held at the Ford Centre in Frisco Texas, USA.

This event is by invitation only and New Zealand is invited every three or four years to compete. In 2025, 11 countries participated in the competition.

Anna applied via Lodge Zetland to the Wellington Masonic Youth trust to seek funding to attend and after due consideration the Trustees and Lodge Zetland agreed to sponsor Anna to the total of \$4000. When the good news arrived at the Elliott household, Anna's Dad was very grateful as it meant that the family could relax slightly and enjoy their family Christmas knowing they were supported.

Anna and the family had several innovative fund-raising activities both on the local and wider city communities.

Anna has been competing in gymnastics since the age of five beginning with the Onslow Gymnastics Club and for the last two years with the Hutt Valley Gymnastics Club. Over the last few years this has meant an average of 18–20 hours per week training, and for the last two years she had also started coaching gymnastics teams and taking them to competitions.

At the New Zealand Gymnastics Nationals in Palmerston North in 2024, Anna won the Step 8 Over All-Around winning the National Title (the 4 apparatus of Beam, Floor, Bars and Vault scores)

This outstanding performance led to her being selected in the New Zealand Team to travel to Texas along with the national team.

Anna and her mum travelled to the competition in the USA which was held from 20–23 February and returned with four medals including a silver in the floor competition.

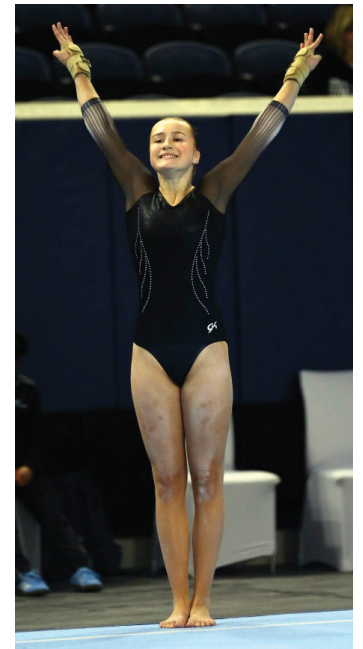

Overall, the New Zealand team achieved a 2<sup>nd</sup> place in the competition.

Anna and her family want to acknowledge the coaches and supporting team who travelled with her and the NZ team and especially to her current coach, but especially want to thank the Wellington Masonic Youth Trust, Lodge Zetland No312, Hutt Valley Gymnastics, Nats, Onslow Gymnastics and others for all their support over the years.



## Publicity for your community events – 3 steps

**BEFORE** Ensure someone is responsible for publicity, arrange for a photographer, plan photographs, involve recipients and find a hook that would interest local media.

**DURING** Seize good photo opportunities, concentrate on 'action' not 'satisfaction', get names for captions, make notes. If media comes ensure that they are looked after and opportunities set up.

**AFTER** Act quickly to spread the word, send press release and captioned high resolution photo, focussing on a newsworthy aspect to local media, district and divisional newsletter and *NZ Freemason*.

# Making a difference in New Zealand

## Two 'Brothers' from different Mothers

Our Grand Master Jim Watt presented 50-Year Service Badges at the Wellington Freemasons Centre to two 'Brothers' who began their masonic journey together

(just a month apart) and have remained with the same Lodge (initially Lodge Island Bay No 243 which later became Lodge Aquarius No 466) for those 50 years.

Kevin Nelson, Past Deputy Grand Master, and Layton Battes, Past Master, they have remained close friends both masonically and in their family lives.

One is often referred to as a 'national treasure', and the other is certainly a 'lodge treasure'.

We will leave you to decide who is which!



## Kiwi Freemasons go to the Far West

Our Grand Master Jim Watt accompanied by Penny took a small delegation to Perth, Western Australia, from 1-3 November 2024 for the Grand Installation of

the Grand Lodge of Western Australia, with MW Bro James Walker being installed as their new Grand Master.

In 2025, we have two further Grand Installations

in Australia that our Grand Master will attend with a New Zealand delegation. All Freemasons and their partners are welcome to join him and Penny.

- ♦ United Grand Lodge of Victoria in Melbourne 21-23 March 2025.
- ♦ United Grand Lodge of Queensland in Brisbane 4-6 July 2025.



Let our Grand Secretary know so you can be added to the New Zealand Delegation.

**FROM LEFT** Adrian Douglas Divisional Grand Almoner – Central (at the time), Amanda Chappel, Paul Chappel Deputy Grand Master, Jim Watt Grand Master, Penny Jackson, Ian Hunt Junior Grand Warden (at the time) and Kevin McKinstry MM, who lives in Western Australia but still belongs to a Lodge in Whangarei.





*On behalf of the United Grand Lodge of Queensland,  
we have the pleasure of inviting you to attend the*

# 2025 Grand Installation

*of RW Bro David Gray DGM as Grand Master*

Friday 4th July

Meet & Greet - \$85pp  
(Pullman Hotel - King George Square)

Saturday 5th July

Ladies Breakfast - \$55pp  
(Pullman Hotel - King George Square)



Grand Installation Ceremony - \$10pp  
(Grand Hall - Masonic Memorial Centre)

Installation Banquet - \$180pp  
(Pullman Hotel, King George Square)

Sunday 6th July

Farewell Lunch - \$120pp  
(Pullman Hotel - King George Square)

Book Tickets



<https://bit.ly/grand-installation-queensland>

Please let our Grand Secretary know if you and your partner want to join our Grand Master and Penny, and the New Zealand delegation to the Grand Installation in Queensland, Australia at [secretary@freemasons.nz](mailto:secretary@freemasons.nz)

# Fire safety isn't just for firefighters

When visiting your friends and whānau, here's what you should look out for:

## 1 Check they have working smoke alarms

**Press and hold the button to sound the alarm to make sure they are working.** If not, replace them straight away. We recommend long-life photoelectric smoke alarms in every bedroom, hallway, and living area and at least one on each level of the house.

**Check the date on their alarm to make sure it isn't expired.** You can do this by looking on the side or bottom of the alarm (you may need to remove it from the ceiling or wall). If the smoke alarm is close to, or older than 10 years – replace it.

**For the Deaf or hard of hearing.** There are specialised smoke alarm systems which have features such as extra loud or lower pitch alarm sounds, flashing strobe lights or vibrating devices.

For more information about smoke alarms for the Deaf or hard of hearing, contact one of the organisations below:

### Your Way Kia Roha

- ➔ Call: 0800 008 011
- ➔ Email: [info@yourwaykiaroha.nz](mailto:info@yourwaykiaroha.nz)

### Deaf Aotearoa New Zealand

- ➔ Call: 0800 332 322
- ➔ Email: [hello@deaf.org.nz](mailto:hello@deaf.org.nz)

## 2 Check their escape routes

**Ask them to show you how they'll get out in a fire and check those exits to make sure they are clear and easily accessible.**

- They should have at least two ways out and a safe meeting place
- The safe meeting place should be located away from the house at the front of the property (e.g. letterbox), so they can safely call 111 from a distance and when firefighters arrive, they know all persons are safe.

For more information on how to help your friends and whānau to create a 3-step escape plan, go to:

**[escapemyhouse.nz](http://escapemyhouse.nz)**

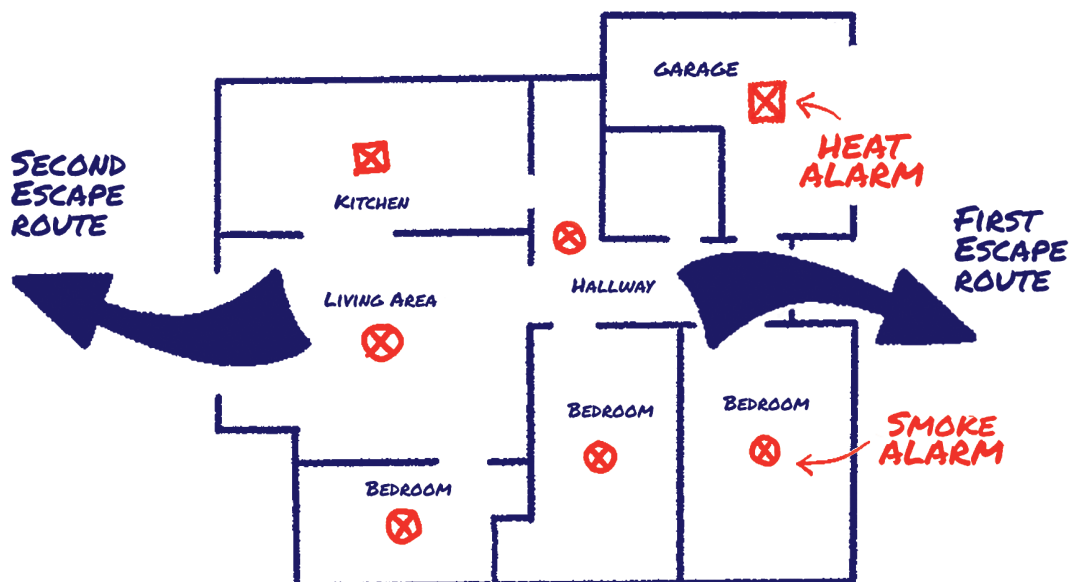

### 3 Be alert to home fire hazards

**Prevent a fire before it starts by helping your friends and whānau to reduce the hazards in their home.**

If you see something that looks unsafe, do something about it.

**Did you know that one in four house fires start in the kitchen?**

- Reduce the risk by making sure your loved ones' stove and rangehood filters are regularly cleaned and keep curtains and tea towels well away from the cooking area
- It is important that cooking is never left unattended.

**Do you notice clothes or furniture too close to the heater when you visit?**

- Heaters and indoor fireplaces should have at least a metre of clear space surrounding them while in use
- Ashes from fireplaces should be placed in a metal bin with cold water, and they should be cooled completely before disposing.

**Look out for overloaded multi-boards in the home.**

- At most, plug in one appliance per wall or multi-board socket
- Never plug a multi-board into another multi-board
- Make sure leads and cords are in good condition and are not frayed.

**Check they are charging devices safely.**

- Items such as phones should never be charged under a pillow or on the bed as they can overheat
- Once an item is fully charged, it should be disconnected from the charger.

**Thank you for helping your friends and whānau to be fire safe.**

For more information on what to look out for in the home go to:

[fireandemergency.nz/home-fire-safety/home-fire-hazards](https://fireandemergency.nz/home-fire-safety/home-fire-hazards)

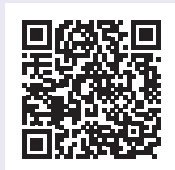

# Elder Care is a cornerstone of Freemasonry

## Ruapehu District Freemasons: Supporting Our Elderly Through Charity and Community.

The Ruapehu District No. 15 Freemasons recently celebrated a significant milestone with the grand opening of their latest charitable project, an initiative aimed at improving the quality of life for elderly residents in our region. This heartfelt event, led by District Grand Master Brian Short, brought together Freemasons, their families, and members of the wider community to mark the completion of a truly meaningful endeavour.

Despite the less-than-perfect weather, the turnout was remarkable, underscoring the strong support and appreciation for this project. Residents and guests alike gathered to witness Brian Short officially cut the ribbon, symbolizing the culmination of months of effort, dedication, and teamwork.

## A Unified Effort to Make a Difference

This project, with a total budget of \$15,500, was made possible through a combination of generous contributions:

- ◆ The Freemasons Charity: \$7,750
- ◆ The Masonic Village Trust: \$1,000
- ◆ Ruapehu District Lodges and Individual Donors: \$6,750

The Ruapehu District stretches from Foxton to Taihape and from Whanganui to Palmerston North. The Lodges in this broad area rallied together, demonstrating the power of collaboration and the shared commitment to supporting our elders. While there may be some small cost overruns, the additional funds collected ensure that every detail of this project is accounted for.

## Gratitude and Purpose

This achievement is a testament to what can be accomplished when communities come together for a worthy cause. The Freemasons of the Ruapehu District are immensely grateful for the support of their members, partners, families, and the wider community who contributed their time, funds, and energy to make this vision a reality.

“We’re privileged to have had the opportunity to give back to our elderly community in such a



meaningful way,” said District Grand Master Brian Short. “Today is a reminder of why we do what we do—our work is rooted in charity, unity, and the belief that together, we can make a difference.”

## A Legacy of Charity

As Freemasons, we strive to uphold the principles of charity, fellowship, and service. This project is more than just an improvement for our local elderly; it’s a reflection of the values that unite us as a fraternity.

The Masonic Villages Trust has Retirement Villages and Care Facilities throughout the North Island, supported by Freemasons in New Zealand.

Thank you to everyone who contributed to making this vision a reality. Together, we’ve demonstrated the strength of our District and reaffirmed our commitment to serving our community with compassion and care.



## We should always remember our Widows

The United Lodge of Wanganui No 468 had the privilege of hosting a delightful morning tea for a truly special group of ladies – the wives of departed Freemasons from the Wanganui area. These wonderful, fun-loving women have been pillars of support to their husbands in their Masonic journey, and it was a joy to show them appreciation during the festive season.

The morning was beautifully organised by Mrs Jo Williamson (Almoner's Assistant), Mrs. Francis Brown, Mrs Angie Tagoai, Ms Baylana Tagoai and Mrs Claire Riach who ensured every detail was perfect, right down to the Christmas tree.

The ladies were treated to a delicious spread of morning tea, and the room buzzed with infectious laughter and lively chatter

as old friends reconnected and shared stories. As a token of our gratitude, each guest received a beautifully wrapped Christmas cake and a thoughtful gift bag to take home. The spirit of togetherness and joy in the room was truly heartwarming, reminding us all of the importance of nurturing these bonds.

At The United Lodge of Wanganui No. 468, we believe in celebrating and

honoring the dedication and sacrifices these remarkable women have made in support of their husbands' Masonic endeavors. It's our way of giving back and ensuring they feel valued and cherished within our community. Our wives, partners, family and friends are always welcome to attend on a regular Lodge evening, making their own entertainment and laughter, for us its a part of our freemasonry and we are richer for it.

Thank you to everyone who contributed to making this event a success! Let's continue to create happiness and strengthen these connections as we move forward.

All of our Lodges in New Zealand support our Lodge Widows.



## Another 70 Year Freemason!

Lyndsay Smith, Past Grand Chaplain, receives his 70-year Service Certificate and Bar from Russell Leader, District Grand Master of the Otago District.

Lyndsay started in Lodge Kurow No 164 in 1954 and transferred to Lodge Oamaru Kilwinning No 82 in 2020. He was Master of Kurow Lodge in 1961, 1987, 2010 and Lodge Almoner for several years.

Also in attendance to celebrate Lyndsay's splendid achievement at the Observation Retirement Village were, from left – Bruce Cawley Master Lodge Oamaru Kilwinning No. 82, John Rudduck Past Grand Warden, Russell Leader District Grand Master, and Bruce Daniell Past Grand Deacon.

Freemasonry creates a lifelong attachment to its fraternity.



# Potter Masonic Trust and Life Education Trust Auckland West: Bringing Learning Back Home

Life Education Trust Auckland West runs two mobile classrooms bringing the classic and beloved Harold the Giraffe to schools throughout West Auckland, from Mt Roskill to Kumeu, Westmere to Piha. Over a full year they teach 10,000 children and support at least 300 teachers of school kids aged between 5-13 years old in the West Auckland area. The registered teachers work in conjunction with school leaders prior to each visit so they can create a tailor-made curriculum to cater to the unique needs at each school visited. They present age-appropriate lessons about the value and effects of healthy foods within our bodies, friendship,

identity and resilience, bullying, online safety, helpful and harmful substances.

However, how often do children come home and not remember what they've learnt that day? To aid in bridging this gap, the Potter Masonic Trust supported the Life Education Trust programme with \$8,695.65 to fund the purchase of take-home activity packs.

By opening their take-home activity pack at home, they are reminded of what they learnt, and those lessons move from short-term memory to long-term memory. Importantly, these activity packs act as conversation starters at home with whanau, enabling the lessons to reach beyond the students and into the wider West

Auckland community. These packs play a critical part in extending the learning from the mobile classrooms back into the home.

In under 5 months of receiving the grant from Potter Masonic Trust, Life Education Trust had visited 46 schools in West Auckland and seen over 7,150 children aged between 5-11 years old. Every single one of the students that visited one of the two mobile classrooms took home an activity pack, which provides opportunities for their lessons to reach over 7,000 families in the wider community.



# Kura Cares Charity: Transforming at-risk boys to men

**K**ura Cares Charity offers a range of free, empowering educational and fitness programs designed to foster personal growth and community engagement. Recently the Potter Masonic Trust granted \$10,000 to Kura Cares Charity to support the delivery of their Positive Pathways Program.

The Positive Pathways Program is designed for at-risk youth and is a key initiative for young juvenile boys aged 14 to 18 years old who have faced severe challenges, including poverty, neglect, and abuse. These experiences often result in behavioural issues and serious situations that hinder their progress and reintegration into society.

The program provides a structured rehabilitation approach that combines outdoor physical activities with personalised mentorship. Participants engage in regular exercise to develop discipline and consistency, while also receiving tailored guidance to cultivate strong mindset and mindful thinking. By integrating restorative methods with fitness components, they are able to holistically address mental, emotional, and physical well-being.

The Positive Pathways Programme has had a meaningful impact on both participants and the wider community,

fostering resilience, leadership, and confidence among young men while strengthening support systems around them.

## Personal Growth and Development

- ◆ Participants have shown significant improvements in confidence, self-discipline, and leadership skills.
- ◆ Many have developed better communication and problem-solving abilities, making them more prepared for future education and employment opportunities.
- ◆ Exposure to new experiences, such as Snow Planet, horse riding, and Tree Adventures, has helped participants overcome fears, build trust, and develop perseverance.

## Community and Family/ Whānau Impact

- ◆ Families have reported positive changes in behaviour, with participants demonstrating more responsibility, motivation, and resilience at home.
- ◆ Schools and educators have noted increased engagement, better focus, and stronger peer interactions among programme participants.

- ◆ The wider community benefits from young men who are making healthier choices, contributing positively to their social circles, and becoming role models for their peers.

## Long-Term Benefits and Sustainability

- ◆ The programme has strengthened connections with local schools, businesses, and activity providers, fostering future partnerships and community support.
- ◆ Employers and training institutions will benefit from a new generation of young men who are more prepared for workplace expectations and responsibilities.
- ◆ The lessons and experiences gained from this initiative will shape future iterations of the programme, making it even more effective for upcoming participants.

The Positive Pathways Programme continues to have a lasting impact, equipping young men with the tools they need to build positive futures while also strengthening the community around them.



# MASONIC EDUCATION

## Discovering Freemasonry: The Treasurer

### Custodian of the Lodge's Finances.

The Treasurer holds the important role of managing the lodge's funds, ensuring financial transparency, and safeguarding its economic health. From tracking dues to authorising payments, your work keeps the lodge functioning smoothly.

### Guardian of Resources.

Your careful stewardship of the lodge's assets reflects the principles of prudence and accountability that every Freemason values. Through your service, you enable the lodge's activities and charitable endeavors to flourish.

### Symbol of Accountability.

As Treasurer, you embody the value of trust, ensuring that all financial matters are handled with the utmost honesty and diligence. Your role exemplifies responsibility and ethical conduct, essential traits of the fraternity.

### Supporting the Future.

Managing the lodge's finances provides a unique perspective on its operations, positioning you as a key advisor and contributor to the lodge's future planning and success.



## Discovering Freemasonry: The Secretary

### The Lodge's Record Keeper.

The Secretary plays a pivotal role in ensuring that the

lodge's meetings, decisions, and member records are accurately documented. Your meticulous work

ensures continuity and preserves the history of the lodge for generations to come.

### Facilitator of Communication.

As Secretary, you manage correspondence with other lodges, members, and Masonic bodies. Your efforts strengthen bonds and maintain open lines of communication, both within and outside the lodge.

### Symbol of Continuity.

Your role signifies the value of consistency and accurate record-keeping. From meeting minutes to membership rolls, your contributions maintain the integrity and legacy of the lodge.

### Key to Lodge Operations.

Serving as Secretary offers a unique leadership position, requiring organisational skills, discretion, and an understanding of Masonic law. You are the go-to resource for lodge information and serve as a key adviser to the Worshipful Master.

### Liases and works with the Grand Secretary and National Office Staff.

As Secretary, you collaborate closely with the Grand Secretary and National Office Staff, ensuring effective coordination, adherence to Freemasons protocols, and support for the lodge's smooth operation at all levels.





# What is the Copestone (or Capstone) and what is its connection to Craft Masonry?

The cope-stone is the topmost brick or stone in a building. We might be familiar with it also being called the Capstone.

Many of us will be familiar with the keystone as the principal locking stone of the Arch but this is not necessarily the Copestone. The Copestone is the top, or cap of the entire wall or roof so is often physically higher than a keystone.

To bring the Copestone forth and to place it in its destined position, it signifies that the building is completed, which event is celebrated, even by the Operative Freemasons of the present day, with great signs of rejoicing.

Flags are hoisted on the top of every edifice by the builders engaged in its construction, as soon as they have reached the topmost post, and thus finished their labours. This is the celebration of the copestone or capstone---the celebration of the completion of the building----when tools are laid aside, and rest and

refreshment take over for a time, labour.

While the keystone was deposited in silence and secrecy; the capstone, as the legend and ceremonies tell us, was placed in its position in the presence of all the Craft and rejoiced. It continues today with the 'roof party' seen on many building sites.

The Ancient Charges of the Craft cite brotherly love as being a virtue that should be cultivated and practised, rather than talked about, by all Freemasons. The true

spirit of Brother Love is essentially, "the Foundation and Capstone, the Cement and Glory of this Ancient Fraternity". It is that cement which Master Masons use their trowel to spread.

Therefore, fellowship is one of the most basic and important concepts in freemasonry.

In the supreme degree of the Holy Royal Arch, the lessons about life and death taught in the three Craft Degrees become complete. Because it completes the Masonic search and imparts

greater knowledge and wisdom, the Holy Royal Arch has been called the copestone of the whole Masonic structure, classed as "the Copestone of Ancient Craft Masonry."

The following obituary notice appeared in March, 1723: "This evening the corpse of that worthy Freemason, Sir Christopher Wren, is to be interred under the dome of St. Pauls cathedral" Just one more extract from the "Compleat Freemason, in 1710, in the eighth year of Queen Anne, our worthy Grand Master Wren, who had drawn the design of St. Paul's, had the honour to see it finished in a magnificent taste, and to celebrate with the Fraternity the copestone of so noble and large a temple."

## Next Question

We all know the phrase, "The light of a Master Mason is but darkness visible...." What is Darkness Visible? Send answers to [secretary@freemasonsNZ.org](mailto:secretary@freemasonsNZ.org)

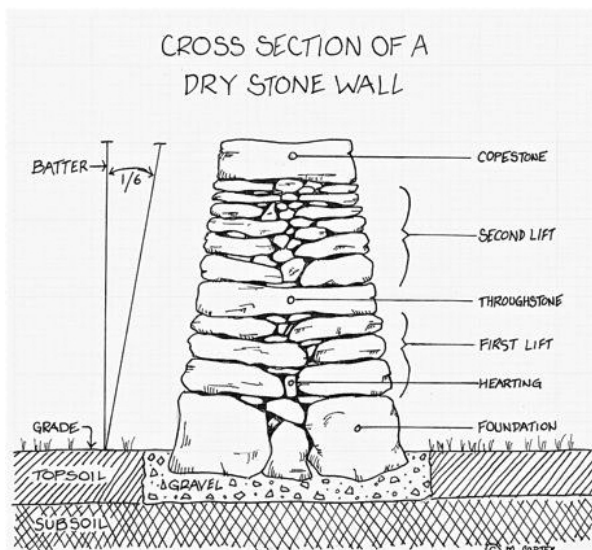

## On masonic leadership (and what you need to know)

From the moment we step into Freemasonry, we are called to uphold the highest standards of character.

Those who take on leadership roles are not merely managing affairs; they are expected to embody Brotherly Love, Relief, and Truth in a way that earns the trust of their Brethren.

A true Masonic leader does not command; he teaches.

He does not seek recognition but earns respect through his actions.

His influence extends beyond the Lodge, shaping his family, community, and all who witness his example.

Leadership in Freemasonry is not about prestige, but service.

He does not ask, "What can I gain?" but... "How can I help my Brethren grow?"

Another prominent obligation of a good leader is the passing on of knowledge.

Freemasonry thrives when its leaders teach, guide, and prepare the

next generation, not just through ritual but also through its deeper moral lessons.

Also, a Mason's leadership does not end at the Lodge door.

His integrity, patience, and charity shape every aspect of his life.

And as times change, so do our challenges.

A good leader balances tradition with progress, ensuring Freemasonry remains relevant while preserving its timeless values.

Leadership is both expected and respected... **expected** because every Mason has a duty to serve, and **respected** because it is earned through character and commitment.

Brethren, leadership is a way of life...

Let us lead not with words but with actions, ensuring that Freemasonry remains a guiding light for future generations.

Credit: MasonicFind



## Our success in 2024 promises to be even greater in 2025

2024 was a very productive year for the Freemasons Foundation. Selected groups and projects throughout NZ benefitted from over \$1.8m of our financial support throughout the year.

The World Choir Games for example, hosted in NZ for the first time, saw choral singing performed throughout Auckland City, with local and international teams participating. Freemasons Foundation proudly supported 7 local choirs from low decile schools, helping them realise their dreams to attend and perform at a globally televised event. Here are some of the other highlights of the year for us...



### Creative young musicians

The Freemasons Foundation continued to financially support both The Auckland Philharmonic Orchestra, Chamber Music NZ and the Manukau Symphony Orchestra – as well as nurturing our young and upcoming musicians. More at [www.manukausymphony.org.nz](http://www.manukausymphony.org.nz)



### Outreach Workshops offered insights for dementia support

Hearing loss, whether due to occupational or age-related factors, can profoundly affect our lives. The Freemasons Foundation is assisting NFDHH to provide support to residents in retirement villages. Find out more at [www.nfdhh.org.nz](http://www.nfdhh.org.nz)



## Trees for Survival prepared for greater growth in 2025

This is an ongoing project strongly supported by the Freemasons Foundation, designed to increase knowledge and enhance hands-on nurturing of NZ's bio diversity with native replanting programmes by groups of young kids. Find out more at [www.tfsnz.org.nz](http://www.tfsnz.org.nz)



## The Big Sing Nationwide

This is a secondary schools choral festival that takes place in 10 centres with 250 choirs and 8,000 singers participating. Only 24 choirs attend the Big Sing Finale. The Foundation enabled the livestream of the Finale, helping students and choir directors who did not make the cut upskill their performance for next year's competition. Watch the performances on [www.nzcf.org.nz/events/nzcf-events/big-sing](http://www.nzcf.org.nz/events/nzcf-events/big-sing)

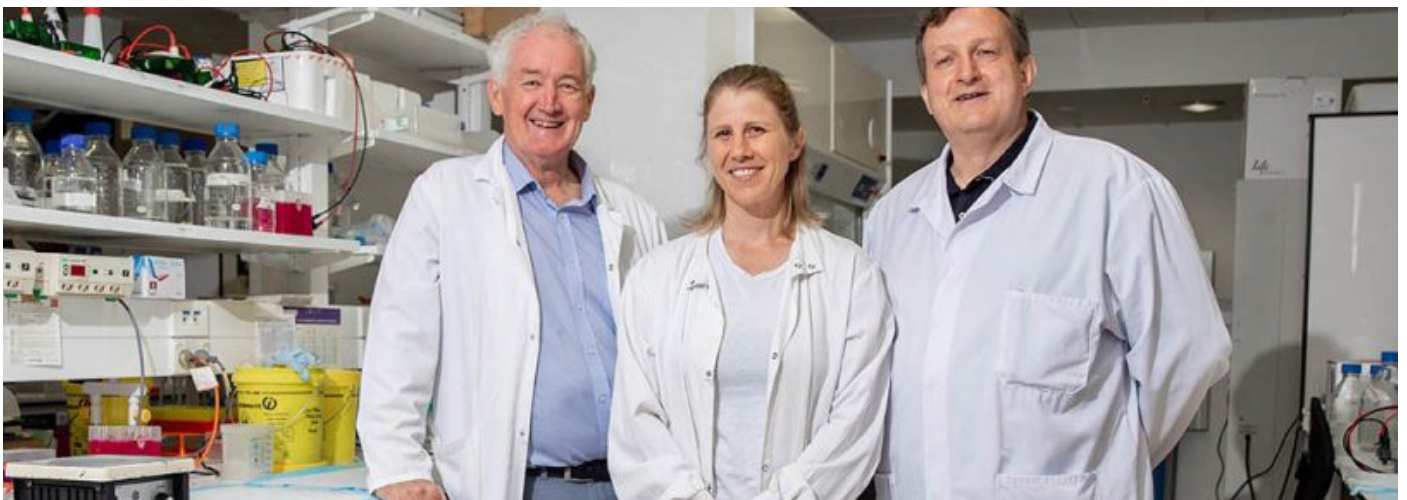

## Bridging Surgery and Science

Dr Jessie Jacobsen (centre) with Professor Russell Snell and Professor Klaus Lehnert at the Centre for Brain Research at The University of Auckland Freemasons Neurosurgery Research Unit:

Jacobsen says the new autism research clinic supported by the Freemasons Foundation will

make genetic diagnosis for autism more widely available in NZ. Research also continues into the causes of dementia in NZ by using sheep studies. 'Sheep serve as excellent models for Alzheimer's disease research due to their longer life span, complex brain structure and genetic similarity to humans' says Professor Snell. Find out more at [www.freemasonsfoundation.org.nz](http://www.freemasonsfoundation.org.nz)

# A New Zealand DeMolay Renaissance

## Building Men of Character in the Land of the Long White Cloud

Nestled amidst the stunning scenery of New Zealand, a remarkable story of brotherhood and purpose is unfolding. In 2011, a group of immigrants, united by their shared experience as members of the International Order of DeMolay, arrived in their new homeland. Yearning to recreate the camaraderie and values that had shaped them in their youth, they embarked on a journey to establish DeMolay in New Zealand.

### DeMolay: A Global Fraternity Building Leaders for Tomorrow

DeMolay is more than just a club; it's a **fraternity for young men aged 12 to 21**. Established in 1919, it's an international organisation with chapters scattered across the globe. DeMolay fosters the development of crucial life skills through a unique blend of activities. From educational events and fundraising initiatives to engaging in service projects, DeMolay provides a platform for young men to learn, grow, and contribute to their communities. But DeMolay's impact extends far beyond practical skills. It instills in its members a deep sense of ethics and moral compass, guided by the Seven Cardinal Virtues:

- ♦ **Filial Love:** DeMolay places great emphasis on honoring and respecting one's parents and family.
- ♦ **Reverence for Sacred Things:** Instilling a sense of respect for all things considered sacred and worthy of respect, regardless of religious beliefs.
- ♦ **Courtesy:** DeMolay promotes treating everyone with politeness and consideration, fostering a more civil and respectful society.
- ♦ **Comradship:** Building strong and lasting friendships based on mutual trust and support is a cornerstone of the DeMolay experience.
- ♦ **Fidelity:** DeMolay emphasizes keeping one's word and being trustworthy, a trait valued in all aspects of life.
- ♦ **Cleanliness:** DeMolay promotes physical and moral cleanliness, encouraging its members to strive for excellence in all they do.
- ♦ **Patriotism:** DeMolay fosters a sense of love and respect for one's country, while promoting responsible citizenship.

By nurturing these virtues, DeMolay empowers young men to become

well-rounded individuals – good sons, strong leaders, and responsible citizens who will leave a positive mark on the world.

### Planting the Seeds of DeMolay in Aotearoa

The DeMolay spirit that bloomed within these New Zealand immigrants was too strong to be contained. Frustrated by the absence of an established DeMolay presence in their new home, they reached out to Freemasonry lodges, hoping to find a connection. Through tireless networking and word-of-mouth, they forged connections with DeMolay members from across the globe, creating a vibrant community that stretched across the North and South Islands.

In 2022, their vision materialized. Aotearoa DeMolay Limited was registered as a non-profit association, solidifying their commitment to bringing DeMolay's positive influence to New Zealand. Recognizing the transformative power of DeMolay in shaping young minds, they are dedicated to sharing the wisdom of the Seven Cardinal Virtues and other valuable

Masonic teachings with the next generation.

### A Brighter Future for New Zealand's Youth

Aotearoa DeMolay Limited aspires to create a nurturing environment where young men can flourish. By becoming a DeMolay chapter, they aim to empower young New Zealanders to develop the qualities necessary to become strong leaders, responsible citizens, and men of outstanding character.

### Join the Movement: A Call to Action

If you are a young man in New Zealand searching for direction, purpose, and brotherhood, Aotearoa DeMolay Limited welcomes you with open arms. They invite you to embark on a journey of self-discovery, develop valuable life skills, and make a lasting impact on your community.

### Contact

Aotearoa DeMolay Limited  
Brother Pol PG Candia  
aotearoademolay@gmail.com  
facebook.com/  
aotearoanzdemolay/

Together, we can build a brighter future for New Zealand's youth, one grounded in strong values, leadership, and unwavering character.



# Special Olympics New Zealand



## One Year To Go Until the Special Olympics NZ National Summer Games!

**F**reemasons New Zealand are the Premier Sponsor.

To mark the one year countdown, hundreds of local athletes and their supporters gathered at Ngā Puna Wai Sports Hub for an Unified Football Have-A-Go-Day, to provide a taste of the inclusion and energy that will be on show throughout Christchurch next year.

The One Year To Go event was also used to introduce All Black captain Scott Barrett as one of the ambassadors for the National Summer Games. Scott's sister Zara has long been competing at the

Special Olympics, so the proud Crusaders forward jumped at the chance to support the event in his hometown.

Representatives of The Freemasons Charity, including the Grand Almoner and Deputy Grand Master attended the event to show our support as the Premiere Partner of the National Summer Games 2025.

Members and Lodges can support the Special Olympics Clubs and athletes and be volunteers at the games – find out more here: [freemasonsnz.org/special-olympics-2](http://freemasons.nz.org/special-olympics-2)



# Less litter, thanks to the Freemasons

In a wonderful show of support and community spirit, Youth Project NZ has secured generous funding to enhance their community involvement.

Thanks to a recent donation from three Local Auckland East Freemasons Lodges of Howick No.314, Wairoa No.55, and The Pakuranga Lodge No 416 in collaboration with The Howick and Districts Masonic Trust and The Freemasons Charity, Youth Project NZ has secured generous funding to enhance their litter-picking efforts as well as custom

T-shirts for their Youth Board.

The funding comes as a part of Youth Project NZ's commitment to fostering community connections and encouraging young people to take proactive roles in preserving the environment. This initiative not only underlines the Organisation's dedication to environmental causes but amplifies the impact of the youth charity's ongoing clean-up campaigns.

With their bright new t-shirts, our Youth Board is more visible and united, boosting community

awareness. The new equipment will further empower our young volunteers to tackle litter more efficiently.

We're thrilled and incredibly grateful for the support from the Freemasons, said Claire Edmondson, Project Manager of Youth Project NZ. "This funding not only allows us to expand our existing efforts but also inspires our young Youth Board to know their hard work is recognised and valued.

The partnership between the Freemasons and Youth Project NZ sets an example

of how collaborative efforts between organisations and community groups can lead to meaningful environmental change.

We hope the local community will look out for our enthusiastic young Youth Board volunteers in their distinctive new attire, making a difference one litter pick up at a time."

For more information about Youth Project NZ and their work, please visit [www.youthprojectnz.org](http://www.youthprojectnz.org) or contact Claire on [claire@youthprojectnz.org](mailto:claire@youthprojectnz.org)



## Sailing Away!

Freemasons supports Sailing for young people. Teamwork, Sailing Skills and Water Safety for the participants.

Sailing scholarship by Howick Sailing Club, for two Howick Intermediate students, Zoe and Jasmine.

This was following two sailing days completed

early in the year, for a group of about 40 Howick Intermediate School students after which these two students were selected by the school's teachers and Howick Sailing Club members, who arranged the outing.

This was funded by a \$6,000 donation from Lodge



Howick No 314 with support from The Howick & Districts Freemasons Charitable Trust

(HFCT) and The Freemasons Charity.

## The Freemasons Charity Paramedicine Scholarship

We are delighted to announce the launch and first ever recipients of The Freemasons Charity Paramedicine Scholarship.

The inaugural recipients of The Freemasons Charity Paramedicine Scholarship for 2024 are:

Carter Hewson, Wanaka  
Casey Happer, Midlands  
Georgina Wadsworth, Wanaka  
Keziah Herd, Canterbury  
Laura Simpson, Marlborough  
Zanna Hammat, Golden Bay  
Patrick Quinn, Dunedin  
Fergus Sharp, Queenstown  
Samantha Hay, Canterbury

This is a new initiative designed to support students pursuing a qualification to become a Paramedic. This scholarship is available to those studying either on-campus or via distance learning at Whitireia/WelTec.

Up to ten scholarships\* are awarded, each valued at up to \$5,000. The program aims to ensure representation across the

Southern Division, with at least one recipient intended from each district.

In keeping with Masonic values, applications are

evaluated based on both academic merit and community service.

A special acknowledgment goes to WBro Graeme Wakelin, Lodge of Progress, for his contribution in proposing this scholarship initiative.

We look forward to supporting the next generation of paramedics through this exciting new program.

More information / Video clip: [www.whitireiaweltec.ac.nz/find-your-future/rosies-story/](http://www.whitireiaweltec.ac.nz/find-your-future/rosies-story/)

\*One \$5,000 Scholarship may be awarded to students studying on-campus or two scholarships of \$2,500 each may be awarded to Students studying by distance learning.



**FREEMASONS CHARITY** **PARAMEDICINE SCHOLARSHIPS**



Are you studying to work in the field as a Paramedic?  
Check out our brand new scholarship

**Open for Applications**  
**1 October - 30 December**



# New Zealand's newest Lodge

Aurora a new dawn and a new lodge.

Aurora Lodge No 477 was constituted and dedicated last weekend at the Petone Freemasons Centre in Wellington by our Grand Master, Jim Watt and his Grand Lodge Team.

The ceremony is steeped in history and involves gold vessels containing Corn, Wine, Oil and Salt and a cleansing Censer. The new lodge Charter including the names of foundation members was read in full by the Grand Secretary and the oration on the new

Lodge was delivered by Kevin Nelson Past Deputy Grand Master, who was also invested as the Grand Representative for the United Grand Lodge of England, in or near The Grand Lodge of New Zealand, at their request.

After a halftime break, the new Master John Hooper and his Officers were installed for the ensuing year. This was followed by a Dinner for Freemasons and partners. Nearly 90 Freemasons were present for this special occasion.







Photos (With thanks to Andrew Alexander District Grand Master Auckland) – Freemasons assembling, Grand Masters Travelling Standard, Duane Williams Grand Secretary reading the Charter, the constitution and dedication ceremony, Grand Chaplain with Censer, programme and oration and investiture of the United Grand Lodge of England, Grand Representative in or near The Grand Lodge of New Zealand with jewel and collarette dating back to 1907.

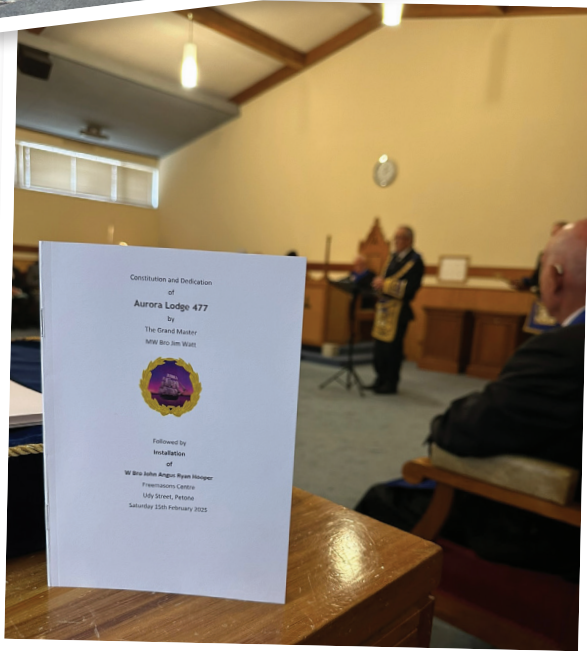

## Happy 2025 to you all -Warick Dunn

It's hard to believe it's March already. It seems like only yesterday we were looking forward to the Christmas break, and now we're a quarter of the way through another year.

And it's been a busy start for the team at The Masonic Villages Trust as we continue to execute our growth strategy, the focus of which is to increase our capacity to support even more older New Zealanders over the years.

The 100-villa Orchard Park extension to our Levin retirement village in Horowhenua is the latest example of this strategy in action. It's been 10 years in the planning so it's very exciting to see building work progressing so quickly and smoothly.

As is the case for every sector of society, retirement living in New Zealand in 2025 will continue to be affected by the changing and challenging conditions that have shaped our economic landscape since Covid.

With more Kiwis living longer and seeking an active, independent lifestyle in their later years, demand for high-quality retirement villages, home care services, and affordable housing options is increasing.

But, one of the biggest challenges remains affordability. As we all know, house prices have dropped and living costs have remained high, making it difficult for some retirees to transition into retirement villages, or maintain a comfortable standard of living once in one.

We are very conscious of these challenges and are confident that our approach to providing retirement living and aged care facilities is flexible, has a focus on affordability and is community-minded enough to support the three big "asks" of people who come to our villages; that all-important social connection, comfort and security at an affordable price.

I'm sure we all hope 2025 will be a better year than 2024. I know our Trust team remains tightly focused on living up to our ongoing commitment to put our residents first. Always.

Thank you for being part of our community in 2025.



**Warick Dunn**  
Chief Executive  
The Masonic Villages Trust



## Good things happening at Edale Care Home -Shaun Brown

"In one way or another," says the Manager of Edale Care Home, Shaun Brown, "I've spent my working life serving and helping people, and I'm still inspired everyday to find ways to make a difference to the people I work with and help look after."

Not a bad philosophy, and one that's certainly helped Shaun make a tangible difference at Edale.

Located in the Rangitikei town of Marton, the Edale Care Home is home to 34 residents. Acquired by The Masonic Villages Trust several years ago, it is now the only care home still operating in the region.

That's because the operating environment for care homes in general has been very challenging financially, Shaun says.

But now, though, Edale is "chock-a-block" and has a waiting list, thanks to the efforts of Shaun and his 45-strong team.

In the 16 months he's been in the role, he's focused very much on enhancing "the environment" within and around the facility.

The team has made significant improvements to the residents' care environment and to the site itself, both around the grounds and inside the rooms.

They found previously under-utilised space on site which they have used to create an extra four rooms, with another two still a possibility. This adds significantly to potential income streams, helping to make the care home more financially sustainable.

And they have worked hard to build relationships within the community, especially health providers.

"Marton's a small place and word gets around quickly," says Shaun, who travels to work every day from Levin.

"People are seeing the difference we are making and that's having a real positive impact and means we stay viable.

"And that's important because we're a major employer locally, and we're now seen as a provider of choice and a good community asset."

Asked about any plans for the future, Shaun says there's still plenty of potential left to leverage at Edale Care Home.

And with The Masonic Villages Trust's ongoing commitment to supporting older New Zealanders to continue to "live locally", he says there's hopefully even more good things to come in Marton.



**Shaun Brown**  
Edale Care Manager



## Work progresses at pace at Levin village extension

Building work proper is now well underway and progressing at pace at the new Orchard Park extension to The Masonic Villages Trust's Levin retirement village.

The first 22 villas in stage one of the build – a mix of one, two and three-bedroom homes – are being built, with the first four ready for hand-over in mid-March.

A further six villas will be complete at the end of April and the rest will be finished by the end of May.

Project Director, Alan Attack, says building work started in October last year with GJ Gardner Homes as the head contractor. "We are seeing the architectural design features coming to life now as the buildings reach completion.

"We will be ready to roll into stages two and three of the construction later this year. Eventually the new extension will add 100 extra villas to the existing retirement village."

Village Manager, Mary Burnett, and her team of 10 staff are excited to see work progressing so quickly.

"It's a wonderful extension for our retirement community," she says.

"We are all really looking forward to having people start to move into their new homes."

Prospective residents are already putting down deposits on the initial villas under construction and more still have expressed interest as additional stages are built.

Initial planning for this village extension started 10 years ago. The work comes hot on the heels of the opening of the new retirement village in Wainuiomata and the rebuilt Woburn Care facility in Lower Hutt.

These projects are all part of The Masonic Villages Trust's ongoing growth strategy as it seeks to fulfil its mission of providing excellent care and support for New Zealand's older communities.





# CCS disability action

Including all people

## TE HUNGA HAUĀ MAURI MŌ NGĀ TĀNGATA KATOĀ

**C**CS Disability Action is the largest pan-disability support and advocacy organisation in Aotearoa New Zealand. We support individuals with all types of impairments and have been working alongside disabled people since 1935. This year, we proudly celebrate 90 incredible years of service and support.

### Why Our Support is Needed

One in four New Zealanders lives with an impairment. Our society does not always operate inclusively. Barriers can be physical, attitudinal, or due to a lack of access to information, resources, and support. These barriers create challenges for disabled people and whānau hauā (disabled Māori).

### Our Approach

Our vision is for every disabled person and whānau hauā to be interwoven into their whānau and community. We partner with disabled people, their

families, and wider whānau to support their choice and control in life. Our support focuses on removing barriers to participation. Our team also supports local communities to become disability-aware, engaged, physically accessible, and inclusive.

### Our Work

We provide direct support to approximately 5,000 children, young people, and adults through our 18 branches, from Northland to Invercargill. This includes a wide range of direct support services and community development programs for disabled people and their communities. Our services include:

- ◆ A variety of respite options designed to give families a break and provide a positive, rewarding experience for disabled children.

- ◆ Community Support Coordinators who advocate and support removing barriers to quality education for disabled children and young people.
- ◆ Connecting people with paid, sustainable employment through individualized support for potential employees and employers.
- ◆ Ongoing vocational support to help disabled people participate in training, work, or community activities.
- ◆ Providing support, information, and options for young people preparing to leave school for further study or employment.
- ◆ Partnering with disabled people to support their independence. We provide community-based support and assist those moving from residential care to their own homes.
- ◆ The Karanga Maha group supports Māori and Pacific Island people in engaging with their cultural identities and developing leadership.

We also offer a nationwide Library and Information Service, providing a wide range of resources on disability and the wider disability sector. Anyone in New Zealand can use the Information Service free of charge.

We also run New Zealand's Mobility Parking Permit scheme, supporting over 170,000 people in accessing their communities

and facilities. We have two divisions focused on improving access for everyday Kiwis. Lifemark advocates for and provides universal design guidelines to improve the accessibility of New Zealand housing, while BarrierFree helps public and private clients create accessible and welcoming buildings, spaces, and transport networks.

### Supporting Our Work in Communities

CCS Disability Action receives a mix of government and philanthropic funding. Government contracts do not cover the full costs of our unique services. Donations enable us to offer more flexible support options beyond standard funding, empowering disabled individuals with greater choice and control over their support. This also allows us to extend our support to those who might otherwise be left without assistance.

Donations help us reach remote areas of New Zealand, covering the additional costs of longer staff travel times. Additionally, they fund crucial activities like advocacy for disabled people and community development work, which are not covered by government contracts.

### Get in Touch

If you would like to learn more about us, we would love to hear from you. Visit [www.ccsDisabilityAction.org.nz](http://www.ccsDisabilityAction.org.nz) to learn more.



# Royal Arch Freemasons invest in eye research

New Zealand Freemasons who are members of the Royal Arch Order meeting in Hamilton this weekend have made a significant investment into research of systemic ageing which could be a game-changer for Kiwis.

The Order's Centennial Award for 2025–2026, of \$30,000 over the two years, has been made to Dr Felix Bird, an ophthalmology registrar at Hawke's Bay hospital. His research, under the auspices of the University of Otago's Dunedin Study on ageing, aims to investigate the relationship between retinal pathology and systemic disease. Ultimately, if a correlation is found, retinal imaging could provide a useful screening measure to identify and prevent disease progression at an earlier stage.

The chairman of the Royal Arch Centennial Award Committee, Geoff Davies, said that the Order is proud to support research which could benefit millions of New Zealanders in the coming years. "Macular disease, which leads to the loss of central vision, could prove to be a reliable indicator of biological ageing, and if so, would provide a cost-effective and accessible means to identify pathological ageing. The potential benefits could be game-changing for identifying systemic disease," he said.

The Centennial Award was established in 1992 and has been made in support of researchers engaged mostly in medical fields such as kidney failure, diabetes, Parkinson's, anti-cancer vaccines and, most recently,

chronic obstructive pulmonary disease (COPD). It is aimed at supporting research work that is of direct benefit to New Zealanders.

"The work we have helped to fund over the 30-plus years of the Award's existence has made a positive difference in many health fields," Mr Davies said.

"However, eye health is a matter for everyone and we are delighted that in Dr Bird's research we have found an opportunity to support a project of significance to all New Zealanders."

## Annual Convocation

The Royal Arch Annual Convocation will take place at the Distinction Hotel, Te Rapa, on Friday March 7 and Saturday March 8. Highlights include the installation of a new First Grand Principal, the national head of the Order, who serves a two-year term in the role. Media inquiries are

welcome and attendance at the Meet and Greet on Friday evening at 6pm, where the Award will be formally announced, and the Installation ceremony at 2.30pm on Saturday afternoon can be arranged. Dr Bird will also be available for interview on Saturday.

## The Dunedin Study

Dr Bird's research is a project of the University of Otago's Dunedin Multidisciplinary Health and Development Study, commonly referred to as the Dunedin Study. It is, to quote its website ([dunedinstudy.otago.ac.nz](http://dunedinstudy.otago.ac.nz)) "an ongoing, longitudinal study of the health, development and well-being of a general sample of New Zealanders. They were studied at birth (1972–73), and followed up and assessed at the age of three when the longitudinal study was established. Since then they have been assessed every two years

until the age of 15, then at ages 18 (1990-91), 21 (1993-94), 26 (1998-99), 32 (2003-2005), and 38 (2010-2012). The Study members have recently been assessed at age 45 (2017-2019) and it is hoped to continue further assessments in the future."

The Study marked 50 years of work and contributions to society in 2023, and Governor-General Dame Cindy Kiro was guest of honour at a birthday function at the university. She said that the Study has been described as the broadest and most in-depth study of human beings ever conducted – that for 50 years, it has been providing us profound insights into why we become who we are.

"The University of Otago and all New Zealanders can be immensely proud of the Dunedin Study ... it remains the worldwide benchmark for a longitudinal study of this kind," she said.



Dr Felix Bird talking at Meet and Greet and banquet after the installation of the new First Grand Principal.



# Convocation 2025

The annual convocation of the Supreme Grand Royal Arch Chapter of New Zealand was held in Hamilton on 7-8 March.

This year was particularly important as not only did the annual meeting of the heads of all the constitutions in Australasia take place here, but also ME Companion Ken Burt was installed as our new First Grand Principal.

A change of format saw our business session held by Zoom in February, which allowed us to have a series of interesting speakers on the Saturday morning before the Installation ceremony. Unfortunately, our first speaker, M Ex Comp Ian Hodgson, was unable to get out of Brisbane due to the cyclone, so gave his talk about Jack the Ripper via Zoom.

Our second speaker, Dr Olwyn Johnson, an internationally recognised expert, and partner of our new First Grand Principal, talked about problems in our education system and in particular the importance of structured literacy.

Our third speaker, Phil Lyon, outlined the Trees for Survival Charity, a schools-based educational programme, whereby children learn about trees

and the climate by growing trees from seedlings and planting them out on farms. This is a charity that has received significant support from the Freemasons Foundation.

As the outgoing First Grand Principal, I would like to thank you all for your support, in particular David Ryan, our Grand Scribe, Paul Sargison, Grand Treasurer, and our three other Grand Principals Ferg McNaughton, Greg Bennett, and David Craddock for the work they have all put in for the greater good of the Order.

I would also like to thank all our Companions for the way they support not only their Royal Arch Chapter but also their Craft Lodge. Surveys show that our members attend their Lodge meetings regularly, and a large percentage are actively involved in senior roles in their Lodges. However, at the same time they find it rewarding to fully support our Royal Arch order.

I wish ME Comp Burt and his team all the very best for their terms.

#### ME Comp Dennis Waller PGZ

The following is extracted from the address given by ME Comp Burt, First Grand

Principal, at the Convocation Installation.

"To distinguished guests, all Companions of the Royal Arch, family and friends, I personally welcome you all today and thank you for your attendance here at the 133<sup>rd</sup> Convocation of the Supreme Grand Royal Arch Chapter of New Zealand.

It is with a sense of humility and a great deal of pride that I am addressing you this afternoon having been installed as the First Grand Principal of the SGRACNZ. Let me also thank Grand Chapter for electing me to this office and placing their trust in me as First Grand Principal.

I would at this stage pay tribute to Most Excellent Comp Dennis Waller for the work he has done for Royal Arch over the last two years. He has, amongst other tasks, driven the publication of six booklets that will, I believe, be of great usefulness in the Masonic education of Chapter members in matters relating to Royal Arch.

In 1842, Freemasonry came to New Zealand with Lodges from the English, Irish, and Scottish Constitutions. The Grand Lodge of New Zealand was formed in 1890.



Freemasonry as a whole has at its base Craft Masonry consisting of Grand Lodge and many Craft Lodges situated throughout the country. It draws its membership from suitable candidates who apply to join.

Over the years Freemasonry at a Craft level has dwindled in numbers. In the 1960s there were 60,000 members but, as we all know, life has socially changed considerably since then. As of 30 June 2024, there were 173 Lodges in New Zealand, from Kaitiāia to the Bluff, with a total of 4,700 members. This was a drop of 3.7% over the previous year. It was heartening, however, to know that propositions to join were up 25, a 10% increase.

Royal Arch Masonry is the next step in the Masonic ladder and relies for its membership on Craft Masonry as each member





of the Royal Arch must be a current member of a Craft Lodge.

The Supreme Grand Chapter of New Zealand was formed in 1892. As at 30 June 2024 there were 762 members in 40 Chapters in comparison with 768 members in 41 Chapters 12 months before. However, in 2020, there were 902 members in 45 Chapters.

The reason that I relate these numbers is that, as an organisation, we have been in a steady decline. Now is the time to act, not next

month, not next year, but now.

Freemasonry as a whole entity must address not only the encouragement of new membership but also the retention of existing members.

Craft Masonry enjoys the fact that the majority of office holders in a Craft Lodge are members of a Royal Arch Chapter.

The retention of members in a Craft Lodge is an issue that can be addressed by jointly working with Royal Arch by encouraging Craft members to join the Royal Arch. The evidence clearly indicates that membership of Royal Arch is a definite factor to retention of membership in Freemasonry.

It is also incumbent on Royal Arch Masons to ensure that they continue to recommend membership

in a Craft Lodge to non-Masons.

As Royal Arch Masons it is also necessary not only to increase membership in our Chapters but to address the issue of retention of members.

Earlier I mentioned the booklets and one of these is for mentors. This will be of interest to senior members of a Chapter and to Grand Chapter officers as it outlines steps that can be taken to educate and retain members in our Chapters. It is my belief that retention of existing members is as important as gaining new members. I also consider senior members of a Chapter should be encouraging and training newer members to do the work rather than doing it themselves.

Lastly, a little bit of history. I joined the Royal Arch in Whetu Kairangi Chapter No 60 in November 1991. It closed in 2007 and I then joined Wellington Chapter No 62.

When I entered earlier, I was escorted by five sitting Chapter First Principals. I am particularly pleased that

the First Principals of No 61, 62 and 63 Chapters have been part of the escort as those Chapters are three that were consecrated in October and November 1926 by the then First Grand Principal Most Excellent Comp T M Rankin: William Ferguson Massey Chapter No 61 on 18 October 1926 at Pukekohe, Wellington Chapter No 62 on 7 October 1926 at Wellington, and Horowhenua Chapter on 22 November 1926 at Levin. To each of the three Chapters he presented a jewel which is worn on the collar of the First Principal of those Chapters and I suspect this may be the first time they have been together.

The three Chapters will each celebrate their centenary in 2026 and I would encourage them to consider the benefits of celebrating that occasion.

I also thank the regalia bearer, the First Principal of Manawatu Chapter No 11.

May you all enjoy the rest of the day and evening and have a safe journey home."

**MEComp Ken Burt 1st Grand Principal**



## Master Masons completing the Masonic journey

Clause 71 of the Freemasons NZ Constitution recognizes three Craft degrees: Entered Apprentice, Fellow Craft and Master Mason; plus the three Royal Arch degrees of Mark Master, Excellent Master and Holy Royal Arch as being pure, antient Freemasonry. We warmly welcome these newly-advanced Mark Masters within our Royal Arch fraternity.

|            |                   |                     |
|------------|-------------------|---------------------|
| 30/10/2024 | Jaden Maycock     | North Shore No 52   |
| 30/10/2024 | Gareth McNaughten | North Shore No 52   |
| 13/11/2024 | Brent Miles       | Tawhiri No 97       |
| 21/11/2024 | James Mercado     | Albert Edward No 6  |
| 27/11/2024 | Michael Bailey    | Carlyle No 74       |
| 03/12/2024 | Hamish McPherson  | Shirley No 86       |
| 10/12/2024 | Martyn Preece     | Kawatiri No 21      |
| 10/12/2024 | Kenneth Hillary   | Kawatiri No 21      |
| 28/01/2025 | Paul Smith        | Marlborough No 14   |
| 15/02/2025 | Richard Hardeman  | Ohinemuri No 17     |
| 17/02/2025 | Myles McHugh      | Mt Maunganui No 103 |
| 17/02/2025 | Peter Williams    | Mt Maunganui No 103 |
| 20/02/2025 | Denver Ilogon     | Albert Edward No 6  |

# The first regular step is taken in Blenheim

Wouldn't this be a great start for every Lodge in New Zealand?

At the February 2025 Regular Meeting of

Lodge Eckford No 334 in Blenheim a First degree was conducted. The Lodge welcomed Brother Mackie into Freemasonry. He took

his first regular step into the Craft.

The First-degree tracing board lecture was presented to Brother Mackie alongside

Brother Turkington, a December 2024 initiate.

Bro Mackie attended an open day afternoon two years ago hosted by Lodge Eckford at the Charles Street Masonic Centre. Once he turned 18, he was still very enthusiastic and engaged the lodge for membership in Freemasonry.



Brother Mackie with Master of Lodge Eckford No 334 and District Grand Master and District Grand Director of Ceremonies.

## Triple First Degree!

Scinde Lodge No 5 in Napier had a Triple First Degree recently (three is a very masonic number) as our masonic year gets off to a good start (and they still have more candidates in waiting).

They have had a very successful Facebook programme in place.

Most Lodges in New Zealand are having a positive start to 2025.



Ian Casement EA, Arun Antony EA, Lodge Master Iulian Dianu and Gavin Robertson EA.



# Welcome to our newest Freemasons

November 2024 – January 2025

|                           |                               |                          |                                   |
|---------------------------|-------------------------------|--------------------------|-----------------------------------|
| Patrick Blakeney Williams | Scinde Lodge No. 5            | Francis Noel Ortile      | Lodge North Harbour No. 182       |
| Gary Bowden               | Scinde Lodge No. 5            | Tamati Mcleod            | Lodge North Harbour No. 182       |
| David Helm                | Scinde Lodge No. 5            | Nino Barrera             | Titirangi Mt Albert Lodge No. 204 |
| Timothy Marfell           | Scinde Lodge No. 5            | Dragan Atanasov          | Lodge Selwyn No. 274              |
| Philip Ryan Moradas       | The Beta-Waikato Lodge No. 12 | Jimmie Mark Go           | Lodge Wanaka No. 277              |
| Robert Oredina            | The Concord Lodge No. 39      | Rashpal Singh            | Lodge Tuakau No. 278              |
| Michael Lister            | The Ponsonby Lodge No. 54     | Arnold Du Toit           | Lodge Howick No. 314              |
| Christopher Doyle         | The Ponsonby Lodge No. 54     | Christopher Turkington   | Lodge Eckford No. 334             |
| Leighton Johnson          | The Franklin Lodge No. 58     | Neil Chand               | The United Lodge No. 340          |
| Adam Moesman              | The Fortitude Lodge No. 64    | John Lazarte             | Lodge Kaimanawa No. 426           |
| Jonathon Hill             | Lake Lodge of Ophir No. 85    | Eliezer Nalla            | Lodge Kaimanawa No. 426           |
| Brandon Hill              | Lake Lodge of Ophir No. 85    | Jayde Cohen              | The United Lodge of Otago No. 448 |
| Edward Quero              | Lodge Arrow Kilwinning No. 86 | Reginald Paul Abordonado | The United Lodge of Otago No. 448 |
| Hugo Vieira Ferreira      | The Waitohi Lodge No. 111     | Peter Cutten             | Meridian Lodge No. 449            |
| Alexandre Ahmed-Assen     | Lodge Rotorua No. 153         | John Paul Siozon         | Lodge Waikato No. 475             |
| Eddun Myel Omambing       | Lodge Rotorua No. 153         | Gerard Baguio            | Lodge Waikato No. 475             |



## QUALITY PAINTING Guaranteed Ltd

For work in the greater Wellington region

Proud to support  
Freemasons New Zealand!

The team at QPG Ltd are experienced, efficient, and always professional. You can be sure you will receive a high quality of service, with great attention to detail and clear, accurate quotes.

- Exterior Painting
- Interior Painting
- Commercial
- Residential
- Educational sector work
- Paper hanging
- Spray-painting
- Annual property care programmes

Phone 04 577 2127  
or 027 282 7557  
Email [steve@qpgltd.co.nz](mailto:steve@qpgltd.co.nz)

[www.qpgltd.co.nz](http://www.qpgltd.co.nz)



# The Last Word!

## Freemasons New Zealand crossword

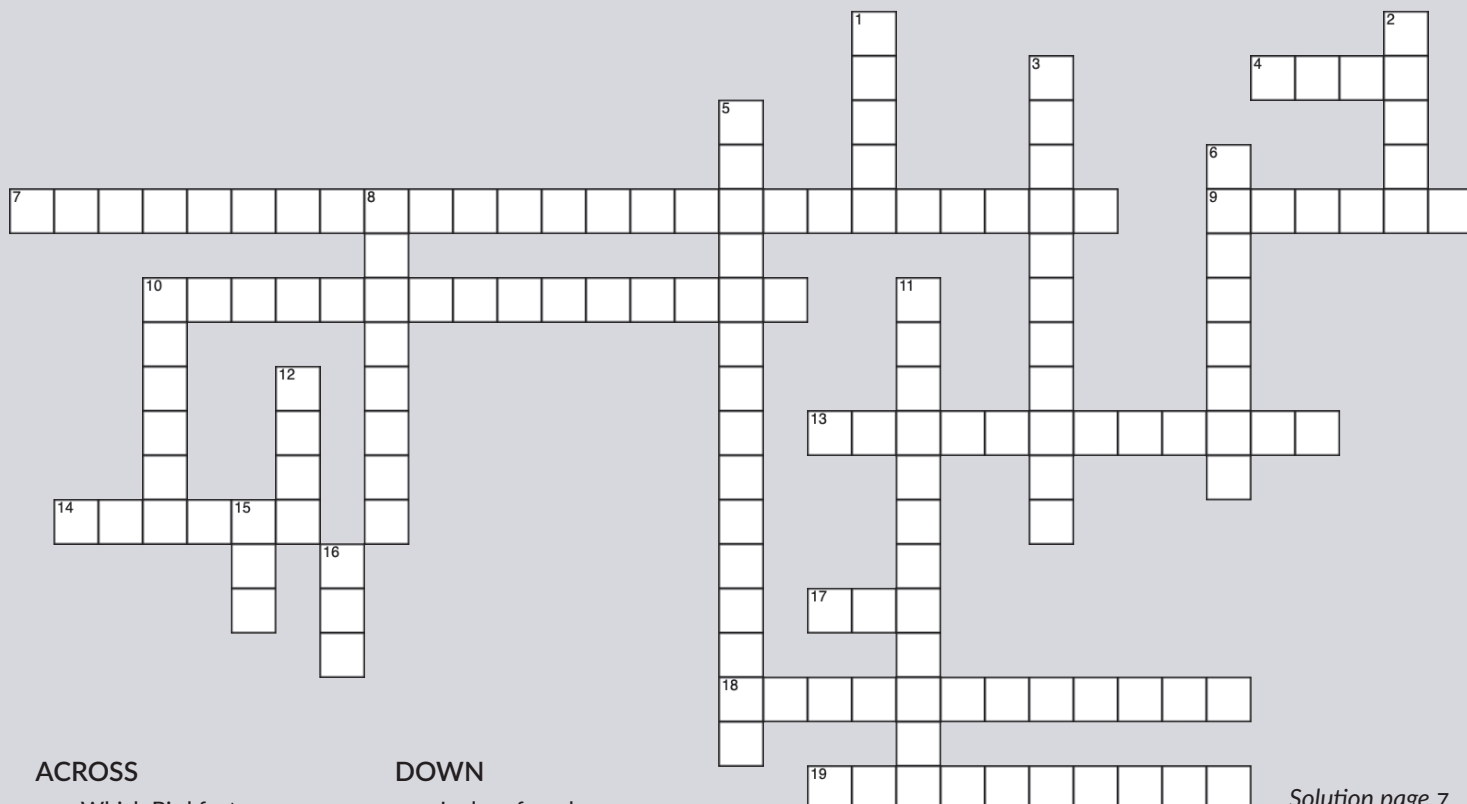

### ACROSS

- 4 Which Bird features on our Coat of Arms?
- 7 What organisation turns 135 on 29th April 2025 (five words)?
- 9 How many years is the highest masonic service bar currently available?
- 10 The Southern Lights are called what (two words)?
- 13 Where is this year's Grand Installation and Communication being held?
- 14 Whose emblem is a dove bearing an olive branch?
- 17 How many Premiers or Prime Ministers of New Zealand have been our Grand Master?
- 18 Special Olympics New Zealand Summer Games 2025 is being held where?
- 19 Who created the new Coat of Arms/Crest for The Grand Lodge of New Zealand in 1986 (three words)?

### DOWN

- 1 Lodges from how many Constitutions help create The Grand Lodge of New Zealand in 1890?
- 2 How many Governor Generals of New Zealand have been our Grand Master?
- 3 The emblem of the Compasses belongs to whom (two words)?
- 5 Freemasons New Zealand (The Freemasons Charity) are Premier Sponsors of what 'Special' event (two words)?
- 6 What month has 28 days or sometimes 29 days?
- 8 29 Days in a month every 4 years is called a.....(Two words)?
- 10 What was the name of one of the first European ships to come into Wellington harbour?
- 11 Who was The Grand Lodge of New Zealand's first Grand Master (two words)?
- 12 Aurora in Latin means what?
- 15 What is the honorific for the Order of Service to Masonry (initials)?
- 16 The number for New Zealand's newest Lodge is.... (numerals)?

Solution page 7

For every man who aspires to be a better person, Freemasonry helps you develop the knowledge and skills to be the best you can be – through a unique mix of ceremony, fresh thinking and good works in an enjoyable and supportive environment, because only Freemasonry uses long-proven principles that empower you to unlock your full potential, for a better future.

# SERVICE AWARDS

November 2024 – January 2025

## 70 YEAR BADGE

Bro Keith Vincent Dellow MM Lodge Waikanae No. 433

## 60 YEAR BADGE

RW Bro Robert Bruce Miller P Prov GM The Advance Mawhera Lodge No. 61

W Bro Sydney Nicholson Broadley PM The Cromwell Kilwinning Lodge No. 98

Bro William Douglas Feasey MM Te Awahou Lodge No. 133

W Bro John Charles Andersen Francis PM RH Lodge Rangitane No. 369

Bro William Thomas Pease FC Meridian Lodge No. 449

## 50 YEAR BADGE

W Bro Roderick Stuart Fraser Craig PM Patea Kilwinning Lodge No. 18

W Bro Graeme Lawson Evans PG Swd B United Lodge of Masterton No. 19

W Bro Ian William Yarlett PM The Heretaunga Lodge No. 73

W Bro David John Landells PGBB The Alpha Lodge No. 81

W Bro Edward Francis Clouston PM Lodge Dunstan No. 103

W Bro Noel Richard Brinsdon PM RH Lodge Winton No. 108

Bro Charles Frederick Smail MM Lodge Switzers No. 223

VW Bro Robert John Jessop P Dist GM Lodge Kawerau No. 422

RW Bro Kevin John Nelson P Dep GM Lodge Aquarius No. 466

W Bro Layton Battes PM Lodge Aquarius No. 466

W Bro Graeme Bruce Calman PM The United Lodge of Wanganui No. 468

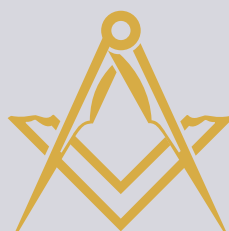

**FREEMASONS**  
New Zealand



# Invest in the Freemasons Deposit Scheme to invest in New Zealand

Heartland Bank is proud to be the Freemasons Deposit Scheme partner. With roots stretching back to 1875, Heartland Bank has a proud history of providing families, small-to-medium sized businesses and farmers with financial solutions to help them achieve prosperity.

Through our partnerships built on shared values, Heartland Bank is working with Freemasons New Zealand to support the Craft in local communities, while providing Freemasons and their families with competitive interest rates on their deposits.

To discuss your specific requirements, contact a dedicated representative on: **0508 FREEMASONS (0508 37 33 62)** or email [freemasons@heartland.co.nz](mailto:freemasons@heartland.co.nz).

Freemasons New Zealand is not a promoter of and does not guarantee the obligations of Heartland Bank Limited in relation to Heartland Bank deposits. Heartland Bank's current Disclosure Statement, Product Fact Sheets and Account and Service General Terms and Conditions are available at [heartland.co.nz](http://heartland.co.nz) or by calling 0508 FREEMASONS (0508 37 33 62).



**FREEMASONS**  
New Zealand

**HEARTLAND**  
BANK